



FITTING INSTRUCTIONS

Part Number: **5421100 & 5421110**

Product Description: UNDER VEHICLE PROTECTION.

Suited to vehicle/s: 120-150 SERIES TOYOTA PRADO AND FJ CRUISER.

Please place these instructions in vehicle glovebox when complete.

WARNING

REGARDING VEHICLES EQUIPPED WITH SRS AIRBAG:

When installed in accordance with these instructions, the vehicle protection panels do not affect operation of the SRS airbag.

ALSO, NOTE THE FOLLOWING:

- ◆ This product must be installed exactly as per these instructions using only the hardware supplied.
- ◆ Do not use this product for any vehicle make or model, other than those specified by ARB.
- ◆ Do not remove labels (if any) from this product.
- ◆ This product or its fixing must not be modified in any way.
- ◆ The installation of this product may require the use of specialized tools and/or techniques
- ◆ These instructions are correct as at the publication date. ARB Corporation Ltd. cannot be held responsible for the impact of any changes subsequently made by the vehicle manufacturer
- ◆ During installation, it is the duty of the installer to check correct operation/clearances of all components
- ◆ Work safely at all times
- ◆ Unless otherwise instructed, tighten fasteners to specified torque

ARB 4x4 ACCESSORIES

Corporate Head Office

42-44 Garden St
Kilsyth, Victoria
AUSTRALIA 3137

Tel: +61 (3) 9761 6622
Fax: +61 (3) 9761 6807

Australian enquiries
North & South American enquiries
Other international enquiries

sales@arb.com.au
sales@arb.com.au
exports@arb.com.au

IMPORTANT INFORMATION. GENERAL CARE AND MAINTENANCE

By choosing ARB vehicle protection, you have bought a product that is one of the most sought after 4WD products in the world. Your under vehicle protection panels are a properly engineered, reliable, quality accessory that represents excellent value.



- While these panels have been engineered for strength and functionality care and good judgment should be taken when traversing difficult off-road conditions to minimise damage to panels and vehicle.
- During servicing when panels are removed ensure fasteners are re-fitted to the correct torque values.
- Inspect panels visually on a regular basis. Dirt and foreign matter should be washed out to minimise build-up around hot components. **BE VERY CAREFULL** when removing foreign matter with hands while vehicle is hot or running. Replace any components as necessary. This service can be performed by your local authorized ARB Stockist.

FITTING REQUIREMENTS

REQUIRED TOOLS FOR FITMENT OF PRODUCT:

BASIC TOOL KIT	
INC 3/8 DRIVE SOCKET SET	

HAVE AVAILABLE THESE SAFETY ITEMS WHEN FITTING PRODUCT:

Protective eyewear		Hearing protection	
--------------------	-------------------------------------------------------------------------------------	--------------------	---------------------------------------------------------------------------------------

NOTE: 'WARNING' notes in the fitting procedure relate to OHS situations, where to avoid a potentially hazardous situation it is suggested that protective safety gear be worn or a safe work procedure be employed. If these notes and warnings are not heeded, injury may result.

FASTENER TORQUE SETTINGS:

SIZE	Torque Nm	Torque lbft
M6	9Nm	7lbft
M8	22Nm	16lbft
M10	44Nm	32lbft
M12	77Nm	57lbft

PARTS LISTING

APPLICATION.	PART NO.	QTY		DESCRIPTION
		5421100	5421110	
FIT FRONT PANEL	6522821	-	1	FRONT UVP ASSEMBLY 150 SERIES
	6522836	1	-	FRONT UVP ASSEMBLY 120 & FJ
	6151300	2	2	NUT CAGE M6
	6151303	3	3	NUT CAGE M8
	5811006	2	-	SPACER (120 PRADO)
	6151434	2	-	SHCS M8 X 70 (120 PRADO)
	4581046	2	-	WASHER SPRING M8
	4581044	2	-	WASHER FLAT M8
FIT CENTRE PANEL	6522826	1	1	CENTRE UVP ASSEMBLY
	6151303	1	1	NUT CAGE M8
	6151022	3	3	BOLT M8 X 25
	4581046	3	3	WASHER SPRING M8
	4581044	3	3	WASHER FLAT M8
FIT REAR BRACKET	3758230	1	1	BRACKET REAR MOUNT
	3199915	1	1	CAGE NUT PLATE M10
	6151022	2	2	BOLT M8 X 25
	4581046	2	2	WASHER SPRING M8
	4581044	2	2	WASHER FLAT M8
	6151357	1	1	BOLT M10 SEMS
	6151304	1	1	NUT M10 CAGE
FIT TRANS PANEL	6522820	1	1	TRANSMISSION UVP ASSEMBLY
	6151022	5	5	BOLT M8 X 25
	4581046	5	5	WASHER SPRING M8
	4581044	5	5	WASHER FLAT M8
	6151132	4	4	NUT FLANGE M8
FIT SPACER TO TRANS PANEL	3759302	1	1	TRANSMISSION SPACER
	4581046	2	2	WASHER SPRING M8
	4581044	2	2	WASHER FLAT M8
	6151022	2	2	BOLT M8 X 25
	6151132	2	2	FLANGE NUT M8 X 1.25
	3789203	1	1	DRILLING TEMPLATE
FIT TRANSFER GUARD	3758370	1	1	TRANSFER CASE GUARD

FITTING PROCEDURE



1. **ALL VEHICLES:** Remove O.E panels from vehicle and retain bolts. If fitted with a bullbar remove and retain two lower M6 bolts (M8 for Prado 120) and loosen off the top four M6 bolts on the bullbar stone shield.

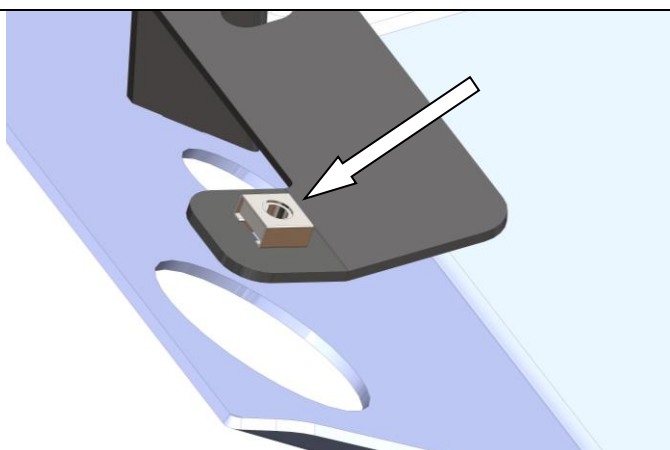

2. **PRADO 150 WITH KINETIC.** Fit two M6 cage nuts to front mounting bracket of panel as shown.

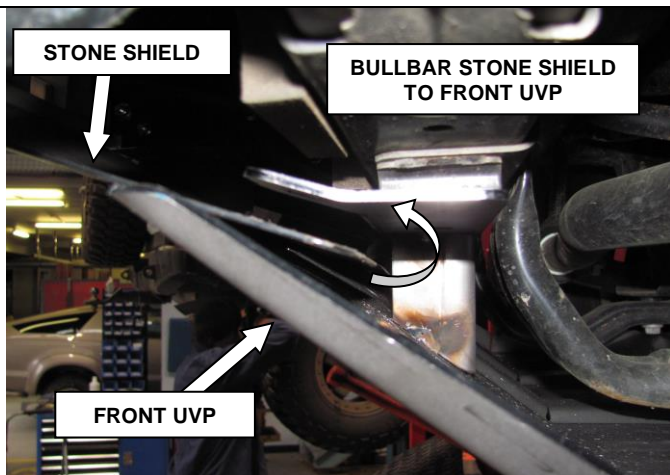

3. Lift front panel into position while placing (if fitted) the bullbar stone shield between the panel and front mounting bracket. Secure panel to chassis using original fasteners and stone shield with M6 bolts removed in step 1. Leave all fasteners finger tight.

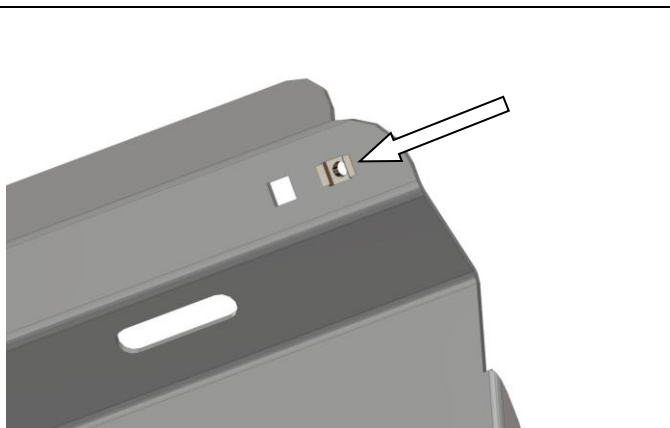

4. **FJ CRUISER.** Fit two M6 cage nuts into front panel as shown. **NOTE:** There are two types of stone shields. Measure distance between O.E stone shield and place cage nuts in correct holes.

FITTING PROCEDURE



5. Place panel onto chassis making sure it sits under the bulbar stone shield as shown. Secure to vehicle using original hardware removed earlier leaving all bolts finger tight. Secure stone tray to UVP using M6 bolts removed in step 1.

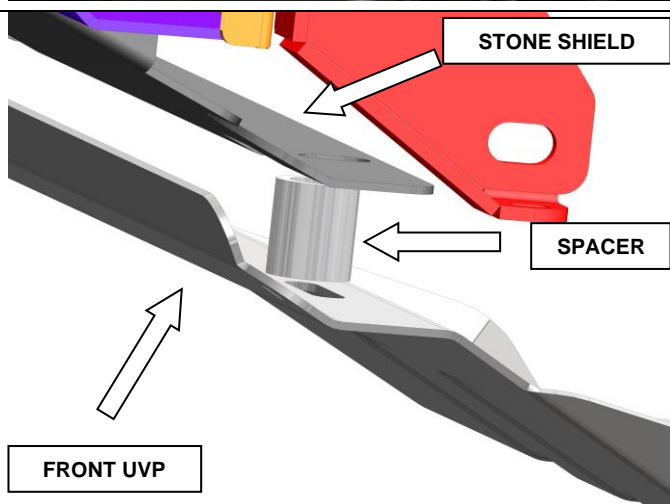

6. **120 PRADO.** As per image place spacer tube between stone shield and UVP. Secure using M8 x 70mm socket head cap screws, spring washers and flat washers. Leave finger tight.

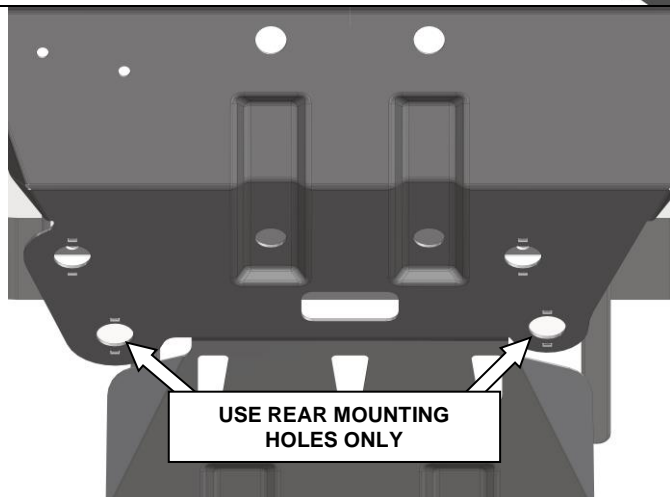

7. **120 PRADO.** Secure rear of front UVP to chassis using original bolts in the two rear most mounting points only. Leave finger tight.



8. **ALL VEHICLES:** Place 3 M8 cage nuts in rear face of front panel.

FITTING PROCEDURE

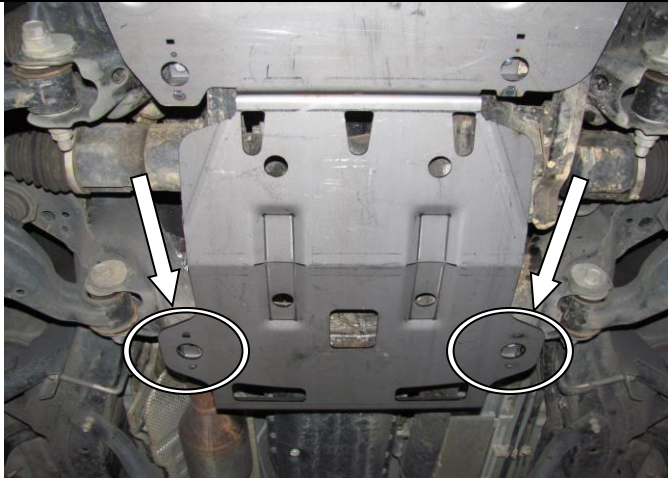

9. Place centre panel on vehicle as shown and secure rear outer mounts to chassis using original fasteners. Leave finger tight.



10. Secure front of centre panel to rear of front panel using three M8 x 25mm bolts, spring washers and flat washers. Leave finger tight.

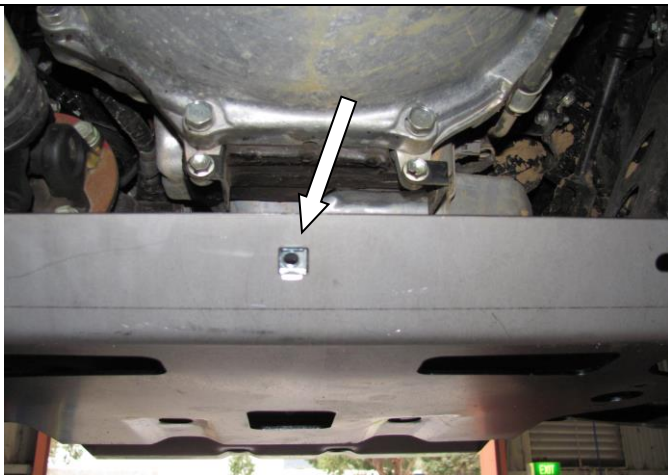

11. Place one M8 cage nut in middle hole of centre panel.

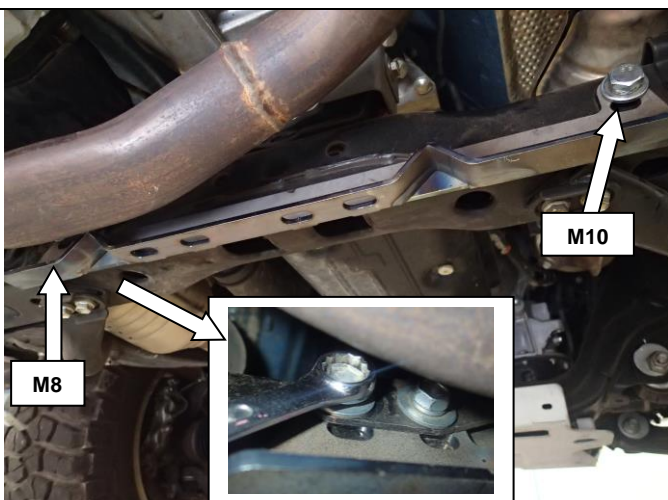

12. Mount rear bracket to rear face of transmission cross member using two M8 x 25mm bolts, spring washers and flat washers on the LHS and one M10 SEMS bolt and M10 cage nut and nut plate on the RHS. **V6 models** use upper holes in bracket and **diesel models** use lower holes (V6 models can use lower holes if exhaust is modified). Un-bolt the front shaft heat shield (petrol only). Place bracket between it and cross member. If you find clearances tight on these models jacking up the exhaust may help. Tighten these bolts now.

 M8 - 22 Nm.  M10 - 44 Nm.

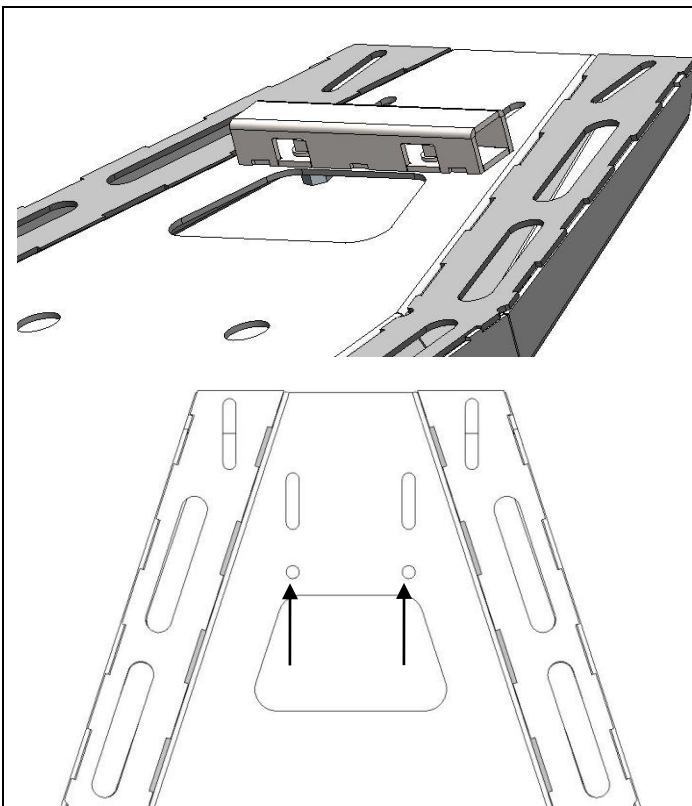

Transmission spacer is for petrol vehicles and vehicles with modified exhaust. If not applicable skip to step 14

13. Using **M8 x 20** bolts, spring washers, flat washers and flange nuts attach spacer to transmission panel.

NOTE: This must be done prior to fitting transmission panel. If transmission panel does not have the two mounting holes please use attached drilling template (3789203) to drill 9mm holes.

 **M8 - 22 Nm.**



14. Lift transmission panel into place and secure to centre panel using three M8 x 25mm bolts, spring washers, flat washers and flange nuts (outer holes only). Leave finger tight.

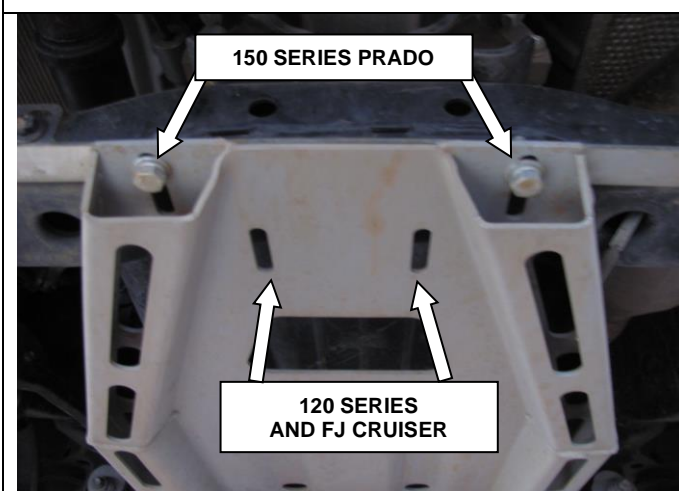

15. **NOTE:** Use outer slots for 150 series and inner slots for 120 and FJ. Secure rear of panel to bracket using two M8 x 25mm bolts, spring washers, flat washers and M8 flange nuts. Tighten all panel bolts when done including front stone shield bolts.

 **M8 - 22 Nm.**

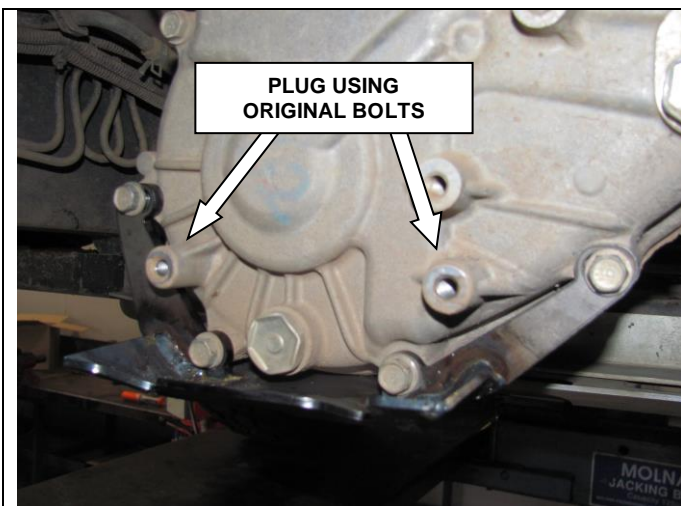

16. Remove original transfer case shield and retain bolts. Remove four lower case bolts and retain. Fit transfer panel as shown using original bolts. Fit remaining bolts into original mount positions at rear.

 M8 - 22 Nm.

FITTED PRODUCT

