



FITTING INSTRUCTIONS

Part Number: **5440300**

Product Description: UNDER VEHICLE PROTECTION

Suited to vehicle/s: FORD RANGER AND EVEREST MY22

Please place these instructions in vehicle glovebox when complete.

WARNING

REGARDING VEHICLES EQUIPPED WITH SRS AIRBAG;

When installed in accordance with these instructions, the vehicle protection panels do not affect operation of the SRS airbag.

ALSO, NOTE THE FOLLOWING:

- ◆ This product must be installed exactly as per these instructions using only the hardware supplied.
- ◆ Do not use this product for any vehicle make or model, other than those specified by ARB.
- ◆ Do not remove labels (if any) from this product.
- ◆ This product or its fixing must not be modified in any way.
- ◆ The installation of this product may require the use of specialized tools and/or techniques
- ◆ These instructions are correct as at the publication date. ARB Corporation Ltd. cannot be held responsible for the impact of any changes subsequently made by the vehicle manufacturer
- ◆ During installation, it is the duty of the installer to check correct operation/clearances of all components.
- ◆ Work safely at all times.
- ◆ Unless otherwise instructed, tighten fasteners to specified torque.

ARB 4x4 ACCESSORIES

Corporate Head Office

42-44 Garden St
Kilsyth, Victoria
AUSTRALIA 3137

Tel: +61 (3) 9761 6622
Fax: +61 (3) 9761 6807

Australian enquiries
North & South American enquiries
Other international enquiries

sales@arb.com.au
sales@arb.com.au
exports@arb.com.au

www.arb.com.au

IMPORTANT INFORMATION. GENERAL CARE AND MAINTENANCE

By choosing ARB vehicle protection, you have bought a product that is one of the most sought after 4WD products in the world. Your under vehicle protection panels are a properly engineered, reliable, quality accessory that represents excellent value.



- While these panels have been engineered for strength and functionality care and good judgment should be taken when traversing difficult off-road conditions to minimise damage to panels and vehicle.
- During servicing when panels are removed ensure fasteners are re-fitted to the correct torque values.
- Inspect panels visually on a regular basis. Dirt and foreign matter should be washed out to minimise build-up around hot components. **BE VERY CAREFUL** when removing foreign matter with hands while vehicle is hot or running. Replace any components as necessary. This service can be performed by your local authorized ARB Stockist.

FITTING REQUIREMENTS

REQUIRED TOOLS FOR FITMENT OF PRODUCT:

BASIC TOOL KIT	TORQUE WRENCH
----------------	---------------

HAVE AVAILABLE THESE SAFETY ITEMS WHEN FITTING PRODUCT:

Protective eyewear 	Hearing protection 
--	--

NOTE: 'WARNING' notes in the fitting procedure relate to OHS situations, where to avoid a potentially hazardous situation it is suggested that protective safety gear be worn or a safe work procedure be employed. If these notes and warnings are not heeded, injury may result.

FASTENER TORQUE SETTINGS (unless otherwise specified):

SIZE	Torque Nm	Torque lbft
M8	22	16
M10	44	32
M12	77	57
OE M12	75 +/- 0.5	55

PARTS LISTING

APPLICATION.	PART NO.	QTY.	DESCRIPTION.
FIT FRONT PANEL	6523518	1	WELD ASSY UVP FRONT PANEL
	4584380	5	WASHER FLAT M10x22.9x2
	6151232	5	BOLT HXHD M10x1.5x30
	6151303	2	NUT CAGED M8 1.8-3.2
FIT DIFF PANEL	6523521	1	WELD ASSY UVP DIFF
	4584393	2	WASHER FLAT M8x19x2
	6151234	2	BOLT HXHD M8x1.25x25
	4584380	5	WASHER FLAT M10x22.9x2
	6151232	5	BOLT HXHD M10x1.5x30
FIT CHASSIS CROSS MEMBER	4570015	1	CHASSIS CROSSMEMBER
	4584380	4	WASHER FLAT M10x22.9x2
	6151232	4	BOLT HXHD M10x1.5x30
	3194639R	2	PLATE NUT FRNT UPR RH
	3194639R	2	PLATE NUT FRNT UPR LH
FIT TRANSMISSION PANEL	6523523	1	WELD ASSY UVP TRANS PANEL
	4584393	10	WASHER FLAT M8x19x2
	6151234	7	BOLT HXHD M8x1.25x25
	6151235	3	NUT FLANGE M8x1.25
FIT FRAME SHIELDS	6523541R	1	FRAME SHIELD
	6523541L	1	FRAME SHIELD
	4654546	4	M8 NUT STICK
	4584393	4	WASHER FLAT M8x19x2
	6151234	4	BOLT HXHD M8x1.25x25

FITTING PROCEDURE

Factory under vehicle protection

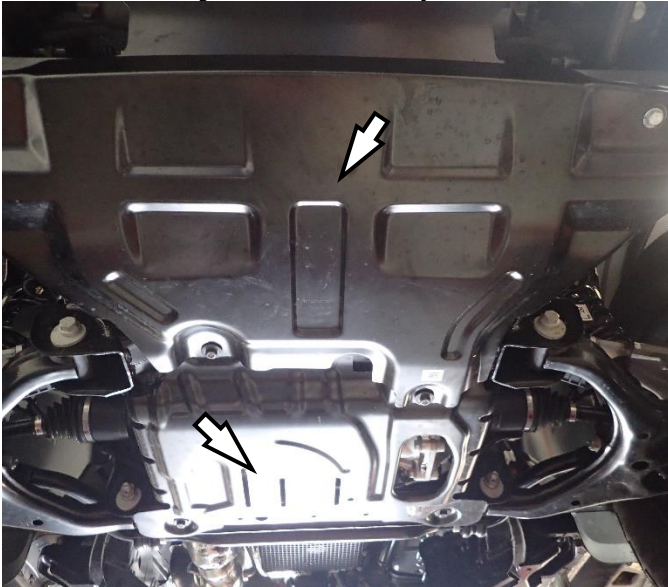

1. Remove factory stone shields from vehicle. Start at the rear and move forward.

Discard the 2 panels and transfer case shield if fitted.

PREPARING OF UVP PANELS



2. Place all the UVP panels on a soft material. Insert two M8 cage nuts into the square holes in the front panel.

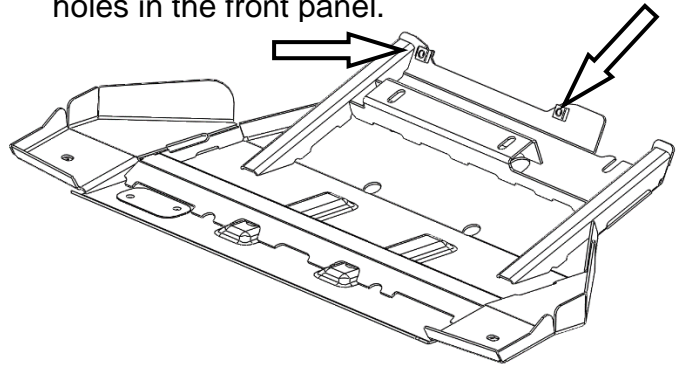

FITMENT OF FRONT UVP

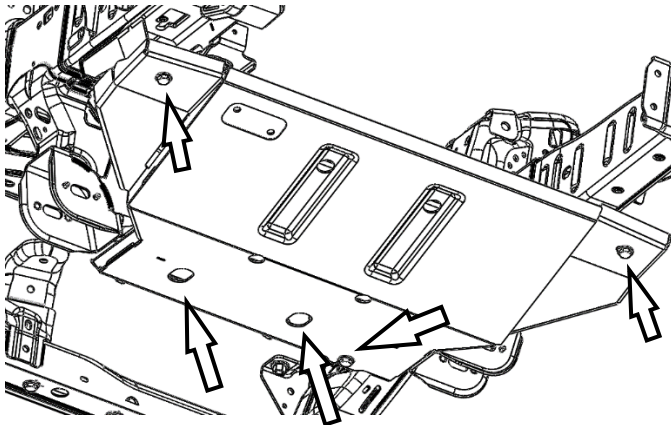

3. Using five M10 x 30mm HXHD bolts & five M10 washers, fit the front UVP panel to the vehicle.

Leave fasteners loose for now.

FITTING THE DIFFERENTIAL UVP

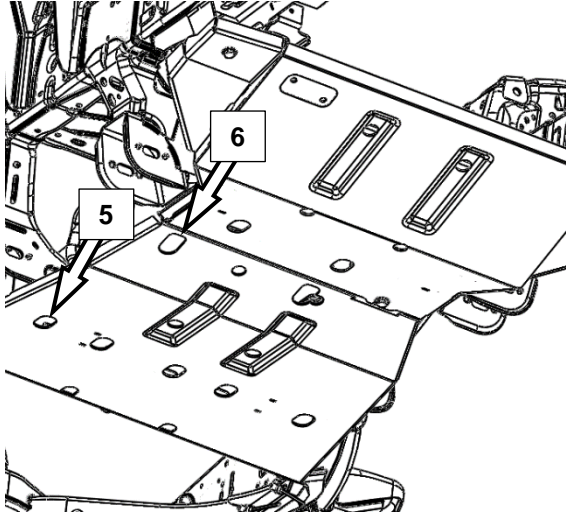

Leave fasteners loose for now.

4. Insert slotted tab on the Differential Panel between the Front UVP and the chassis.
5. While the weight is held by the front, fit five M10 x 30 bolts and washers across the back row starting from the RHS.
6. Fit two M8 x 25 bolts and washers through opening and into the cage nuts fitted to the Front panel.

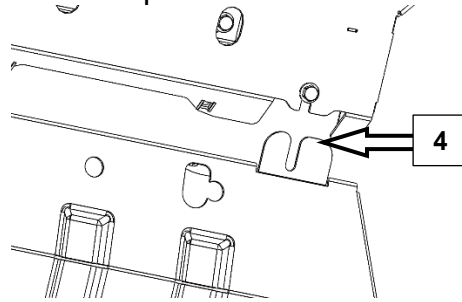

FIT CHASSIS CROSS MEMBER

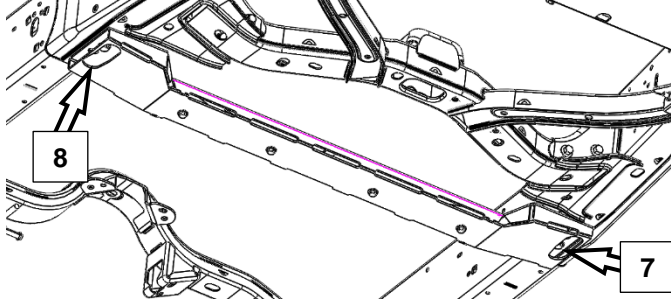

NOTE:

If a Transfer case shield was fitted, there will be J-nuts fitted to the chassis on the LHS.

7. Attach the cross member to the chassis using two M10 x 30 bolts and washers to fit to the J-nuts.

If J-nuts are **not** present use two M10 Nut sticks, 1 LHS and 1 RHS as shown.

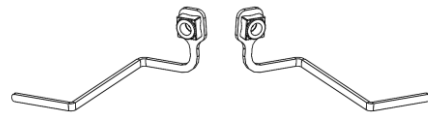

Use the access hole in the chassis to align the mounting holes with the nut sticks.

8. Insert one Left & one Right nut stick into the access hole in the RHS chassis and use two M10 x 30 bolts and washers to fasten the cross member to the chassis.

Leave fasteners loose for now.



FIT TRANSMISSION UVP

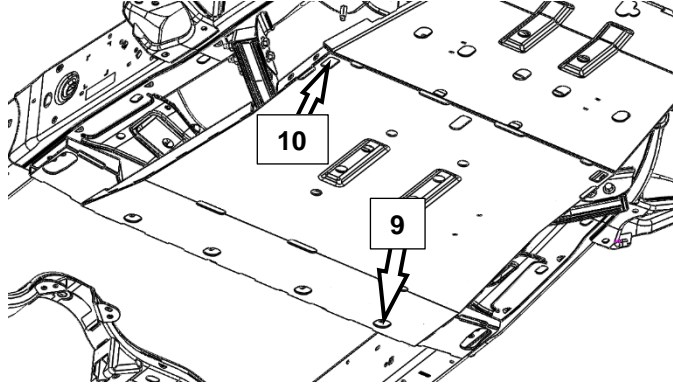

9. Using a stand, lift the Transmission panel into place. Along the rear, use four M8 x 25 bolts and washers to fit the transmission panel to the crossmember.
10. Use 3 x M8 x 25 bolts, washers and M8 flange nuts to join the Transmission panel to the front differential panel.

Leave fasteners loose for now.

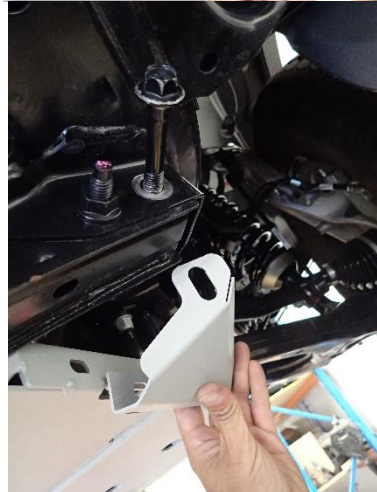

11. Remove outer K-frame bolts from chassis. Reverse the direction of the bolt in the K-frame and fit the side wings, start the nut so the wing will hang on the bolt.

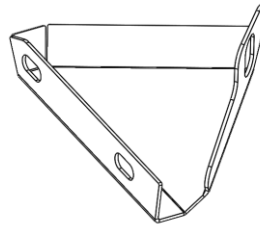

12. Insert two M8 nut sticks into the channel from the inside of the UVP. Using two M8 x 25 bolts and washers per side, attach the wings to the UVP panel.

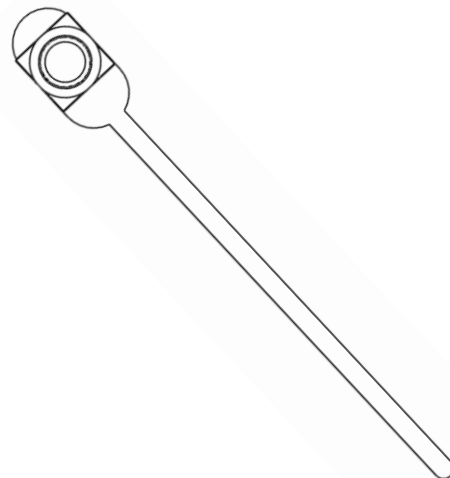
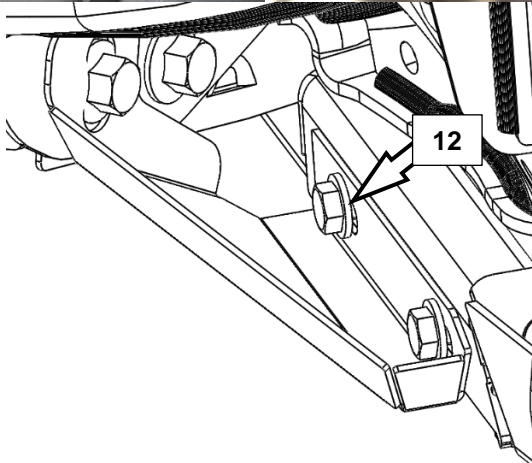

Leave fasteners loose for now.

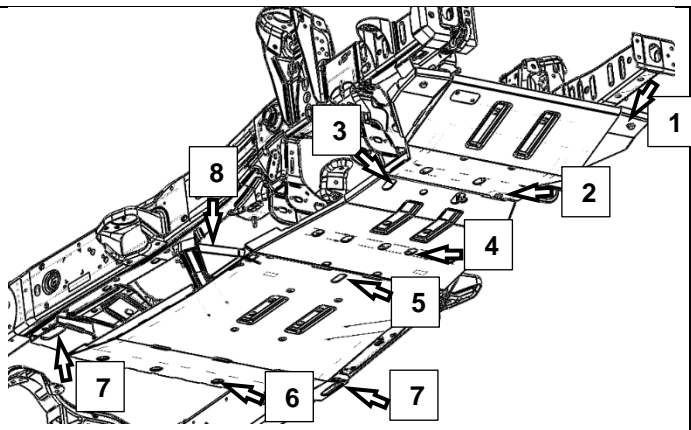

13. Once all panels and fasteners are fitted, start from the front and tighten all the fasteners to the rear. Use the Torque table on page 2 for each Torque setting.

NOTE:

When fastening one panel to the next panel, make sure they are lined up so to not have the rear most panel below the forward edge.

NOTICE:



M12 K-frame bolt - 75Nm

FITTED UVP

