

BP5190009L & BP5190009R

ISUZU DMAX FRONT (2012 – 2019)

HOLDEN COLORADO FRONT (2012 – ON)

WARNING

- ◆ This product must be installed exactly as per these instructions using only the hardware supplied.
- ◆ In the event of damage to any suspension component, contact your nearest authorised ARB stockist. Repairs or modifications to the suspension system components must not be attempted.
- ◆ Do not use this product for any vehicle make or model, other than those specified by ARB.
- ◆ Do not remove labels from suspension components.
- ◆ This product or its fixing must not be modified in any way.
- ◆ The installation of this product may require the use of specialized tools and/or techniques
- ◆ It is recommended that this product is only installed by trained personnel
- ◆ These instructions are correct as at the publication date. ARB Corporation Ltd. cannot be held responsible for the impact of any changes subsequently made by the vehicle manufacturer
- ◆ During installation, it is the duty of the installer to check correct operation/clearances of all components
- ◆ Work safely at all times

Note: These fitting instructions should be read in conjunction with the vehicle workshop manual.

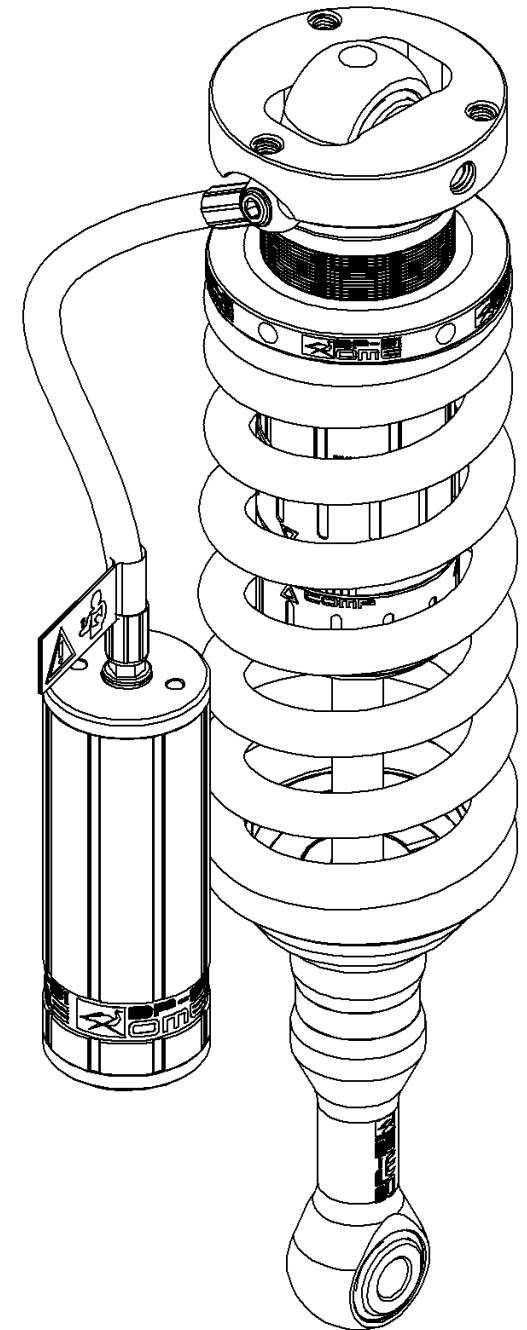

FITTING KIT CONTENTS – VM80010030

Item	Description	Qty.	Part No.
1	BRKT RESI: ISUZU DMAX FRONT R	1	VE10020039R
1	BRKT RESI: ISUZU DMAX FRONT L	1	VE10020039L
2	MOUNT: RESERVOIR CLAMP	2	VE10010003
3	TOOL: ADJUSTER TOOL	1	VC10010071
4	BP51 FASTENER KIT DMAX FRONT	1	VM60010023
4.1	M10 x 1.5 x 30	6	6151555
4.2	WASHER FLAT M10 X 24 X 4	2	4584361
4.3	M6 X 1.0 X 16	4	VD60030003
4.4	WASHER M6	4	VE70020005
4.5	M6 NYLOCK	4	VD60010003
5	F/INST BP-51: DMAX FRONT	1	VM90010050
6	MANUAL: OWNERS MANUAL	1	VM90020001

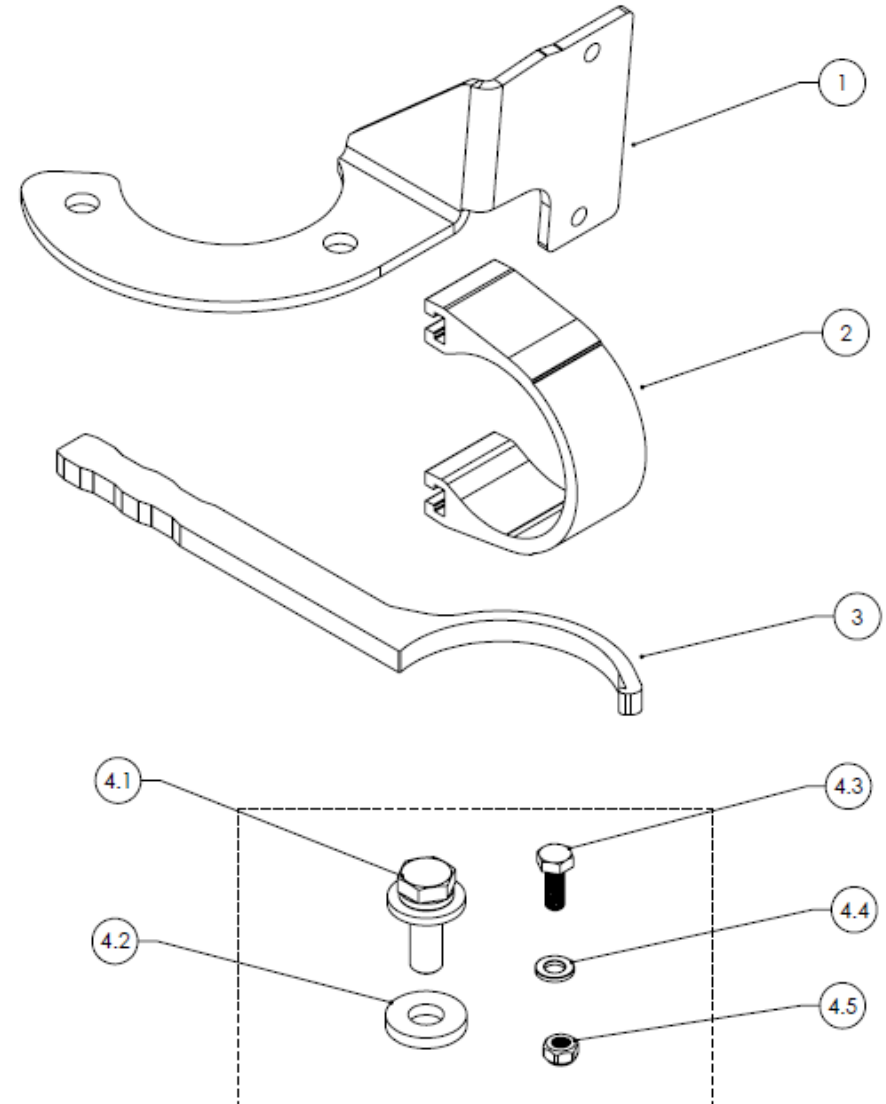

DAMPER PREPARATION (SPRING PRE-LOAD ADJUSTMENT)

Before fitment, the spring preload may need to be adjusted to suit your front accessory fitment and desired ride height.

Use workshop tool kit VM80020001 to aid spring adjustment.

Refer to BP-51 Service and Parts Manual 1.2_Coilover Spring Adjustment for more detail.

The preload is set at the factory to 20mm as shown by the diagram. This aims to achieve around 25mm increase in ride height over OE when a Bull bar and a winch are fitted.

Preload must be set before the strut assembly is fitted to the vehicle. Use a spring compressor to compress the spring, loosen the pinch bolt (1) on the preload ring and adjust (2) to the desired setting (See table below).

Tighten the pinch bolt and remove the strut assembly from the spring compressor.

As a guide, set the preload as specified below to achieve around 25mm (1") increase in ride height.

Front Accessories	Preload (mm)
Bar, Winch, UVP +	25
Bar & winch	20
Bar only	15
No accessories	5

Spring preload must only be adjusted when a spring compressor is used to take load off the preload ring.

DO NOT attempt to adjust preload with load on the spring when fitted to the vehicle.

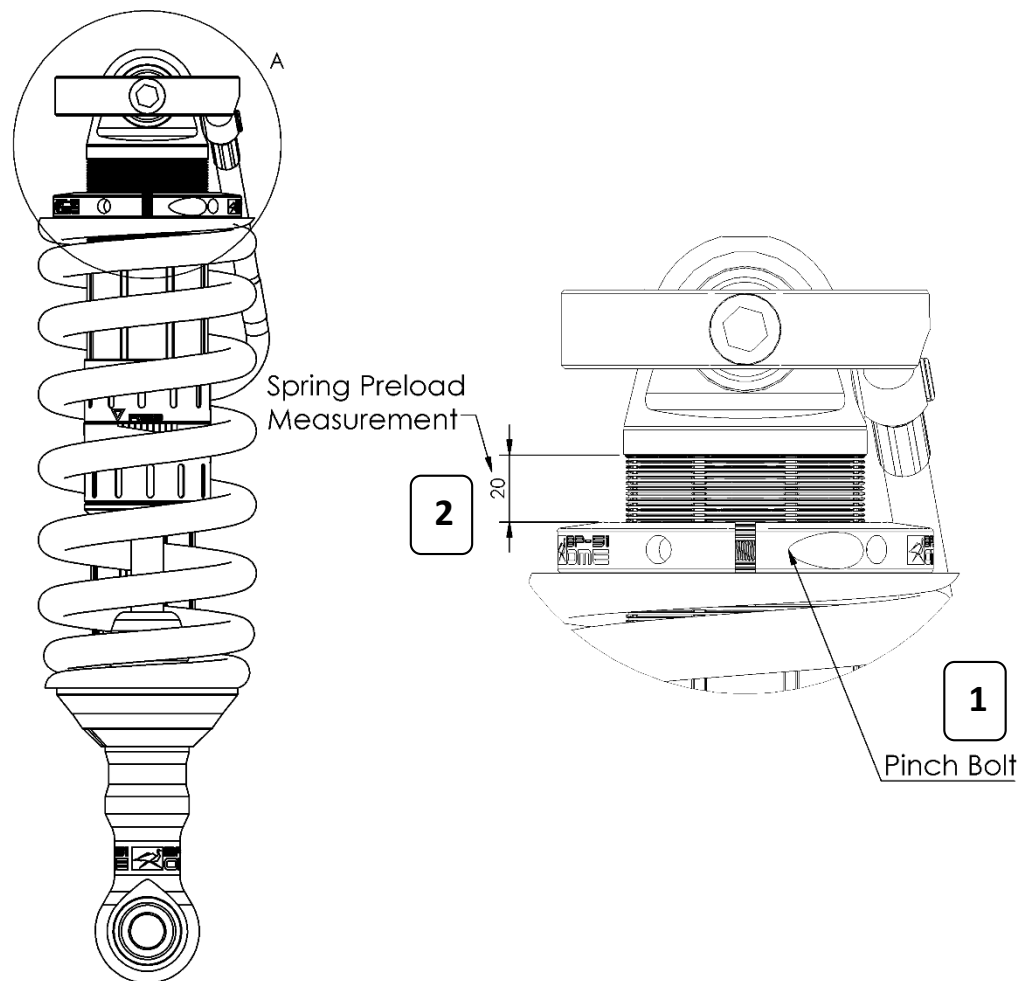

VEHICLE PREPARATION (REMOVING STRUT)

Use the following steps as a guide to remove strut. Isuzu D-max workshop manual may also be used where available to guide strut removal.

1. Remove wheel.
2. Support the Lower Control Arm with a jack stand or similar.
3. Detach ESC line.
4. Remove lower damper mount nut (do not remove bolt)
5. Loosen the top mounting nuts (X3)

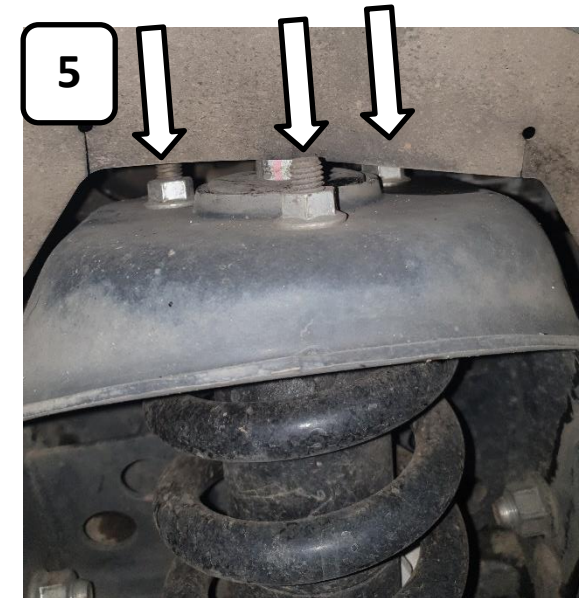
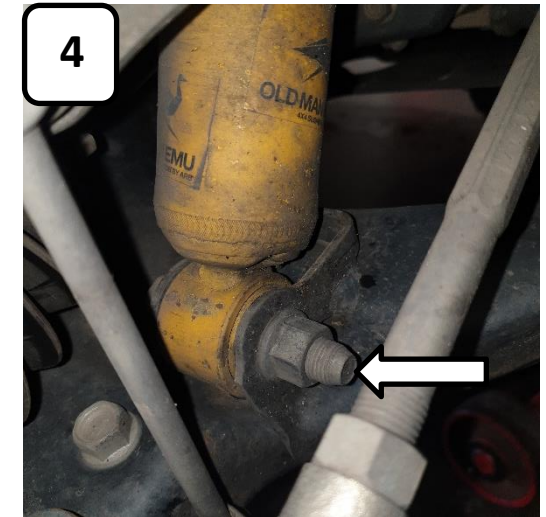
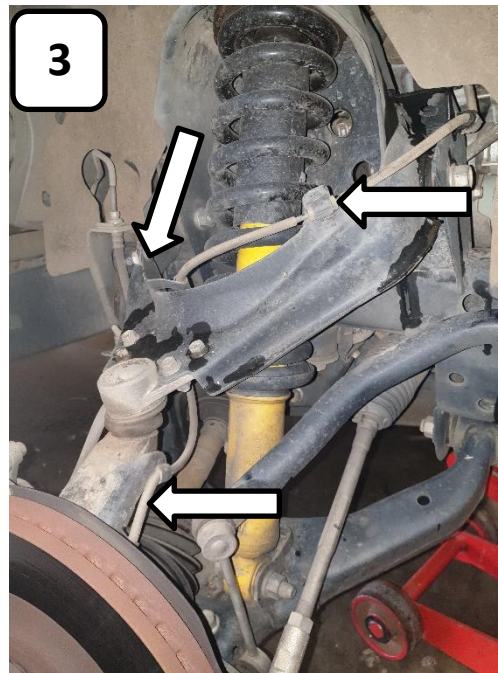

**VEHICLE PREPARATION
CONTINUED...**

6. Detach the tie rod from steering knuckle.
7. Detach the sway bar link from the upright.
8. Detach the steering knuckle from the upper control arm (UCA) by removing the 4 bolts. Take care to prevent the drive shaft from dropping out.
9. Remove lower mounting bolt and remove the strut from the vehicle.
10. Detach sway bar from chassis and create clearance to remove the strut from the vehicle. (optional)

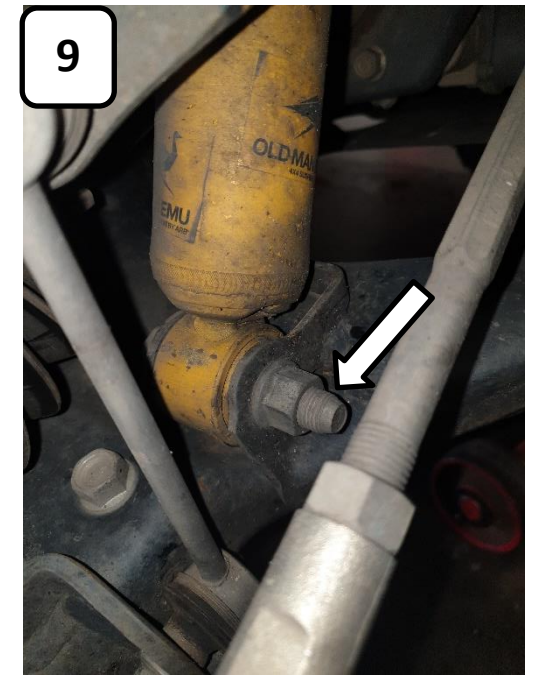
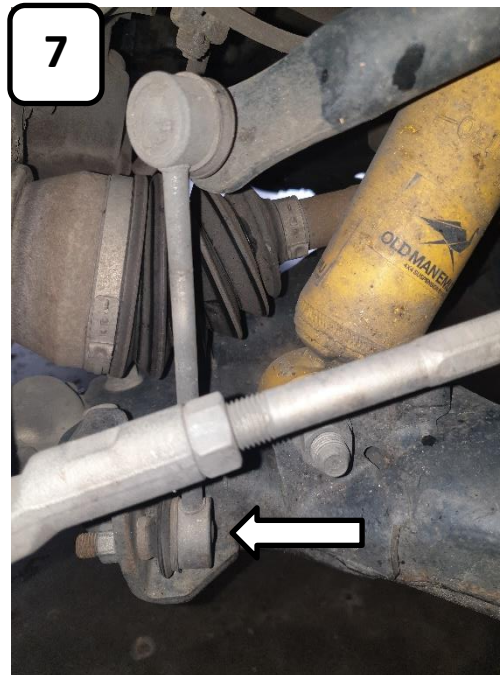
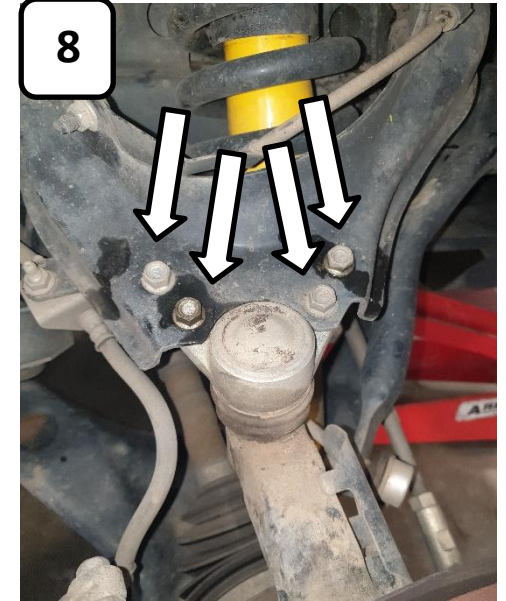
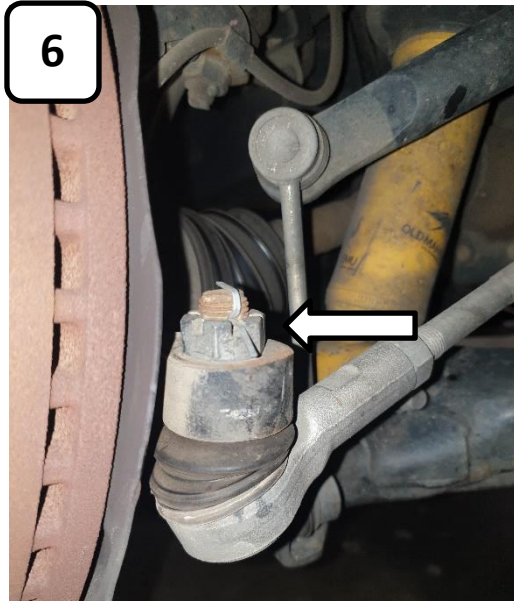

DAMPER AND RESERVOIR MOUNTING SEQUENCE

Left and Right Hand sides are the same with the exception of the way the hose exits the damper. L and R should be etched on the damper part number. When mounted in the vehicle the hose and reservoir should be to the rear of the strut tower.

Right hand side shown

Top Mount:

1. Pre-assemble reservoir bracket as shown
2. Feed the reservoir through the upper control arm, followed by the shock body
3. Locate the lower eyelet of BP-51 in the lower shock mount. Do not fasten.
4. Fit the top hat to the chassis mount. Secure **ONLY** the top using the rear front threaded hole shown in the picture. Finger tight only.

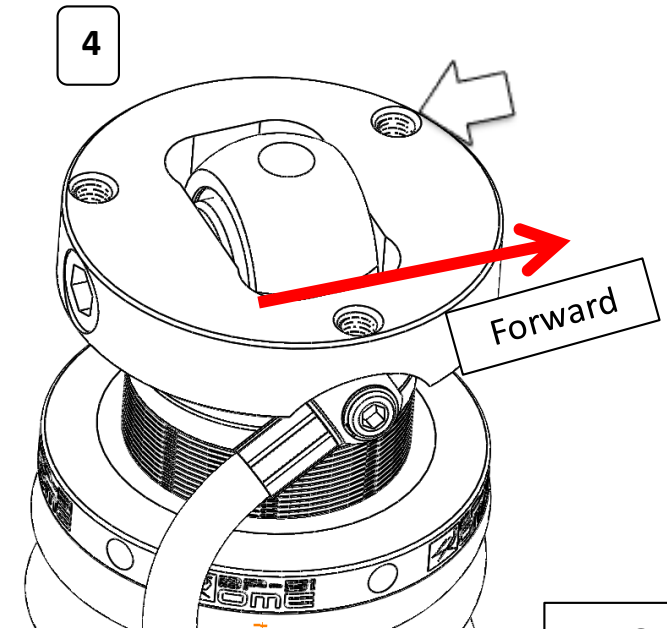
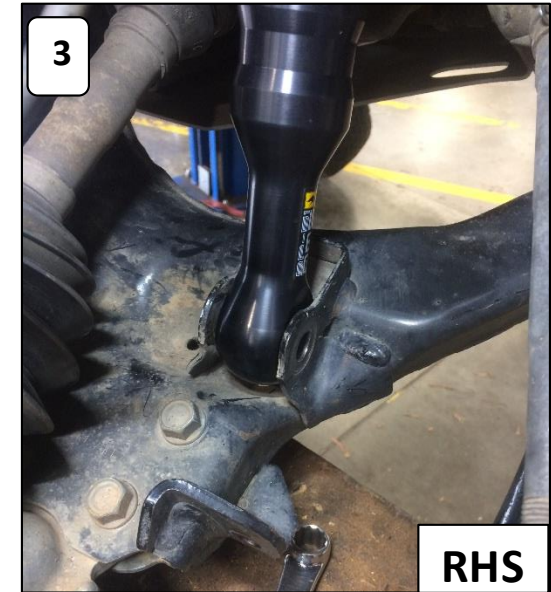
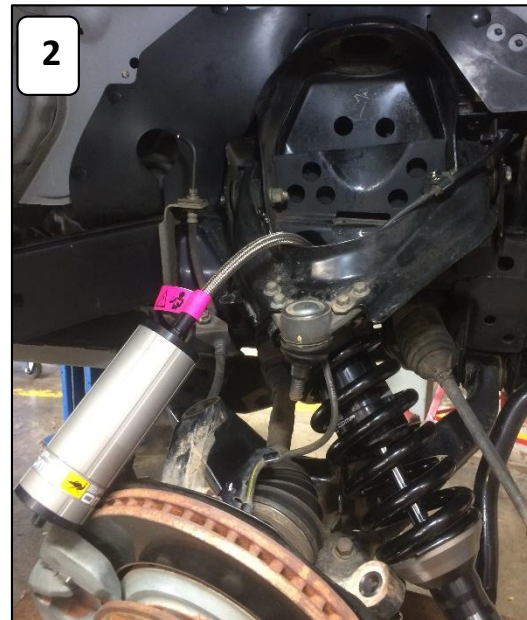
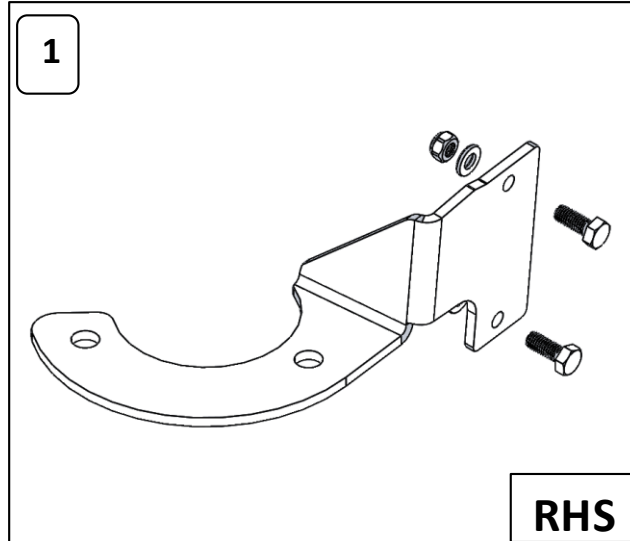

Fastener	Torque settings
Fastener	Torque N.m (ft.lbf)
Upper Control Arm M10	31 (23)
Sway Bar Link	64(47)
ESC Bracket	6 (4)
Strut to Lower Control Arm	127(94)
Steering Tie Rod to Knuckle	63 (46)
Top Shock Turret	44 (32)

5. Fit the resi bracket to the top mount as shown in the picture.
 Caution: When fitting fasteners to secure the BP-51, ensure the **6151555 (M10 BOLT)** above the hose fitting **MUST** have a 4mm thick Washer spacer **4584361** between fasteners and the reservoir bracket. **(5b)**

 **6151555, 44 N.m (32 ft.lbf)**

6. Fit the bolt and nut to the lower mount.

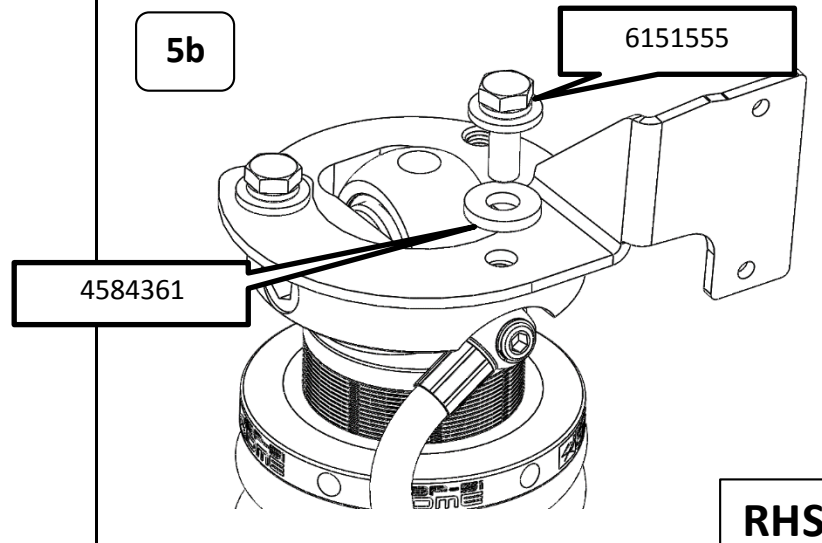
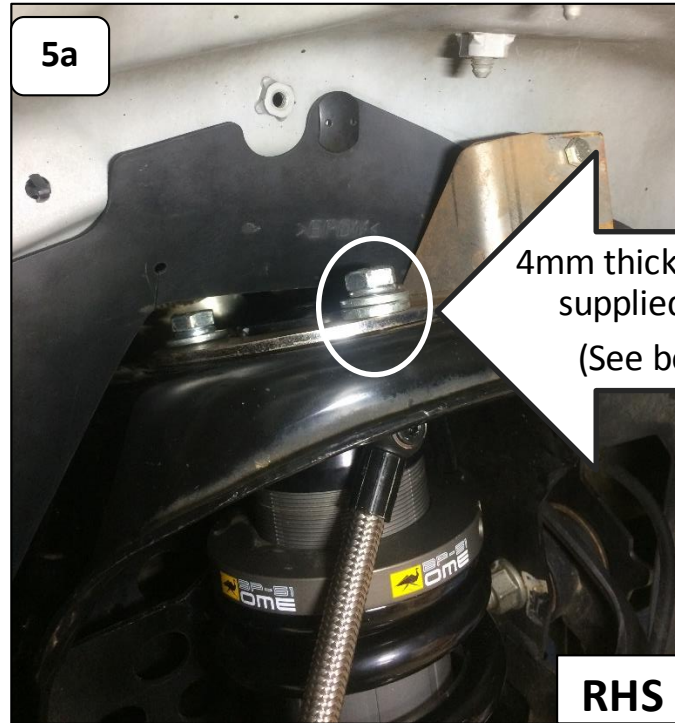

7. Reattach all the components to the vehicle in a reverse way of detaching them.

- Lower Eyelet
- Upper control arm M10 (s)
- Sway bar link
- Tie rod to steering knuckle
- Top shock turret
- ESC cable

8. Fit Resi bracket and position it as shown.

Right Hand: 65mm – 70mm

Left Hand: 40mm - 45mm

 **Resi Mount, 12 N.m (9 ft.lbf)**

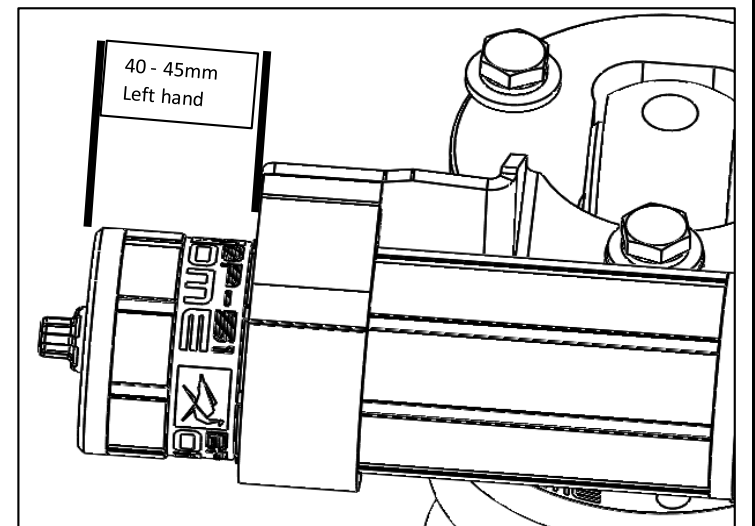
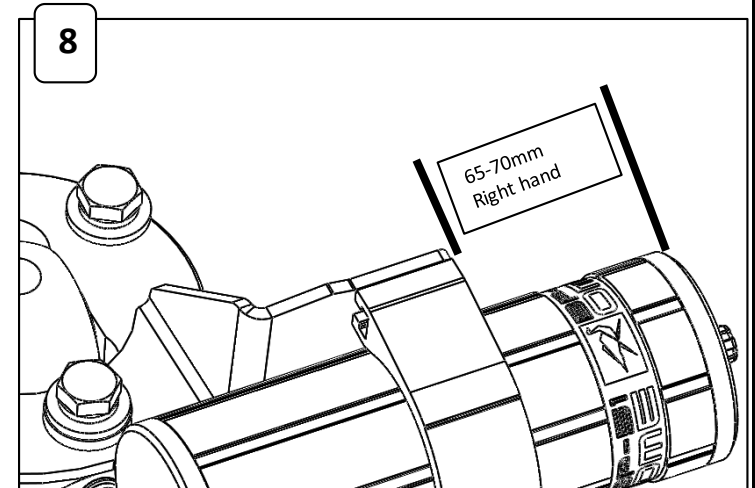
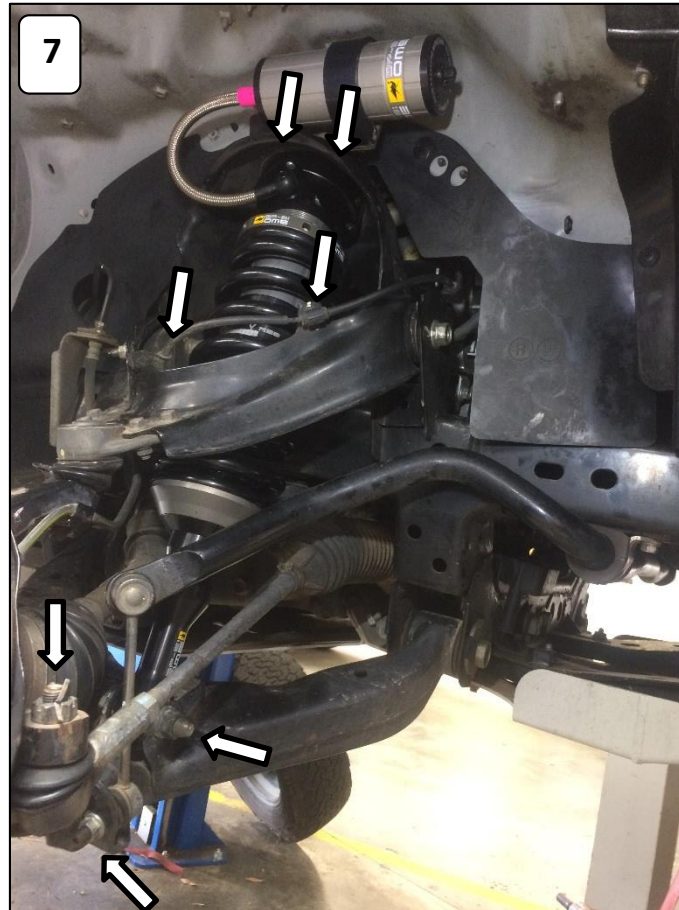

FASTENER	TORQUE N.m (ft.lbs)
Strut to Lower Control Arm	127(94)
Upper Control Arm M10	31 (23)
Sway Bar Link	64(47)
Steering Tie Rod to Knuckle	63 (46)
Top Shock Turret	44 (32)
ESC Bracket	6 (4)

DAMPING ADJUSTMENT

These dampers have been set in the factory to be used for a vehicle with Bull Bar and Winch fitted.

If your accessory fitment differs, use the table below as a guide for recommended Compression and Rebound adjuster settings.

Refer to the Owner's Manual for more information.

Front Accessories	Compression	Rebound
Factory setting	3	6
Bar & winch	4-8	6-10
Bar only	2-6	5-9
No accessories	0-4	4-8

SPECIFICATIONS

- | | | |
|---|-------------------|----------|
| 1 | Extended Length | 516.5 mm |
| 2 | Compressed Length | 411.0 mm |

SPARE PARTS

Refer to Service and Part manual, section: **BP-51 S&P 3.1-BP5190009**

