

BP5190050

SUITS MAZDA BT-50, ISUZU DMAX REAR 2020 ONWARDS

WARNING

- ◆ This product must be installed exactly as per these instructions using only the hardware supplied.
- ◆ In the event of damage to any suspension component, contact your nearest authorised ARB stockist. Repairs or modifications to the suspension system components must not be attempted.
- ◆ Do not use this product for any vehicle make or model, other than those specified by ARB.
- ◆ Do not remove labels from suspension components.
- ◆ This product or its fixing must not be modified in any way.
- ◆ The installation of this product may require the use of specialized tools and/or techniques
- ◆ It is recommended that this product is only installed by trained personnel
- ◆ These instructions are correct as at the publication date. ARB Corporation Ltd. cannot be held responsible for the impact of any changes subsequently made by the vehicle manufacturer
- ◆ During installation, it is the duty of the installer to check correct operation/clearances of all components
- ◆ Work safely at all times

Note: These fitting instructions should be read in conjunction with the vehicle workshop manual.

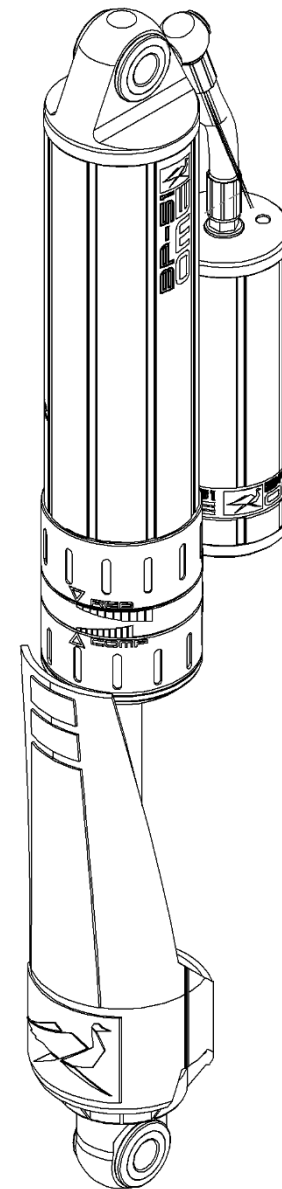

FITTING KIT CONTENTS – VM80010045

Item	Description	Qty.	Part No.
1	BRKT MAZDA BT-50 LOOM REAR	1	VF60050048
2	PACKER 60X134X10	6	5848494
3	TOOL: ADJUSTER TOOL	1	VC10010071
4	ASSEMBLY: PIGGYBACK RESI MOUNT	2	VM20010001
5	WASHER FLAT: ID16.2 OD 24.5 T4	4	4584419
6	BAND CABLE 7 X 140	2	180711
	F/INST BP-51: MAZDA BT-50 REAR	1	VM90010055
	MANUAL: OWNERS MANUAL	1	VM90020001

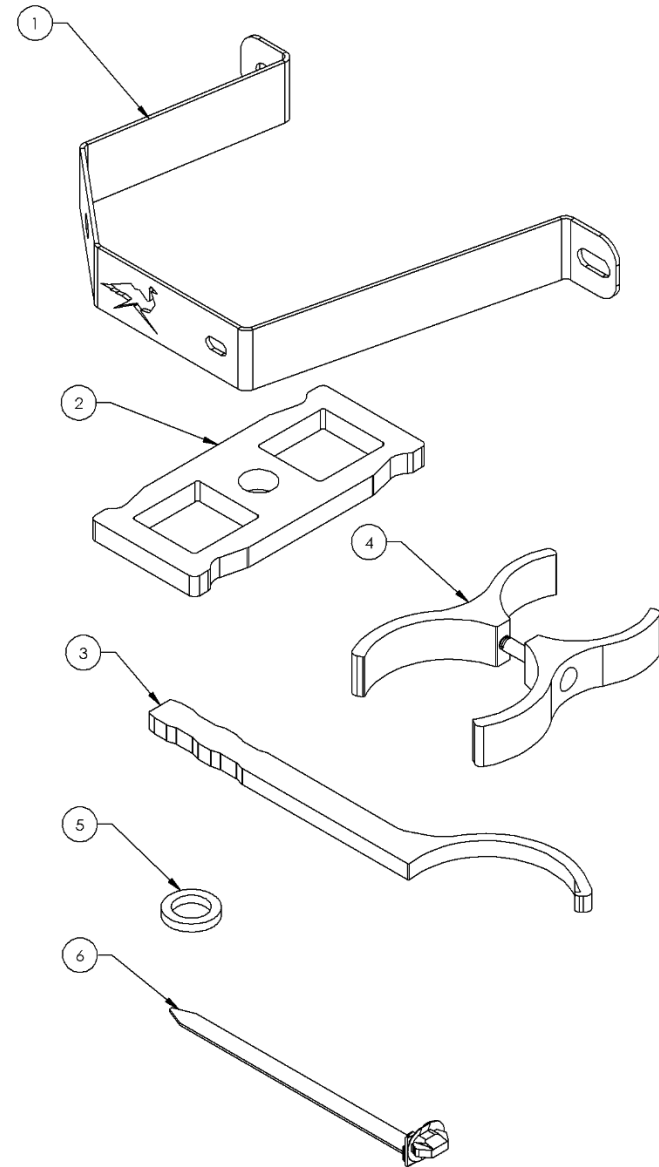

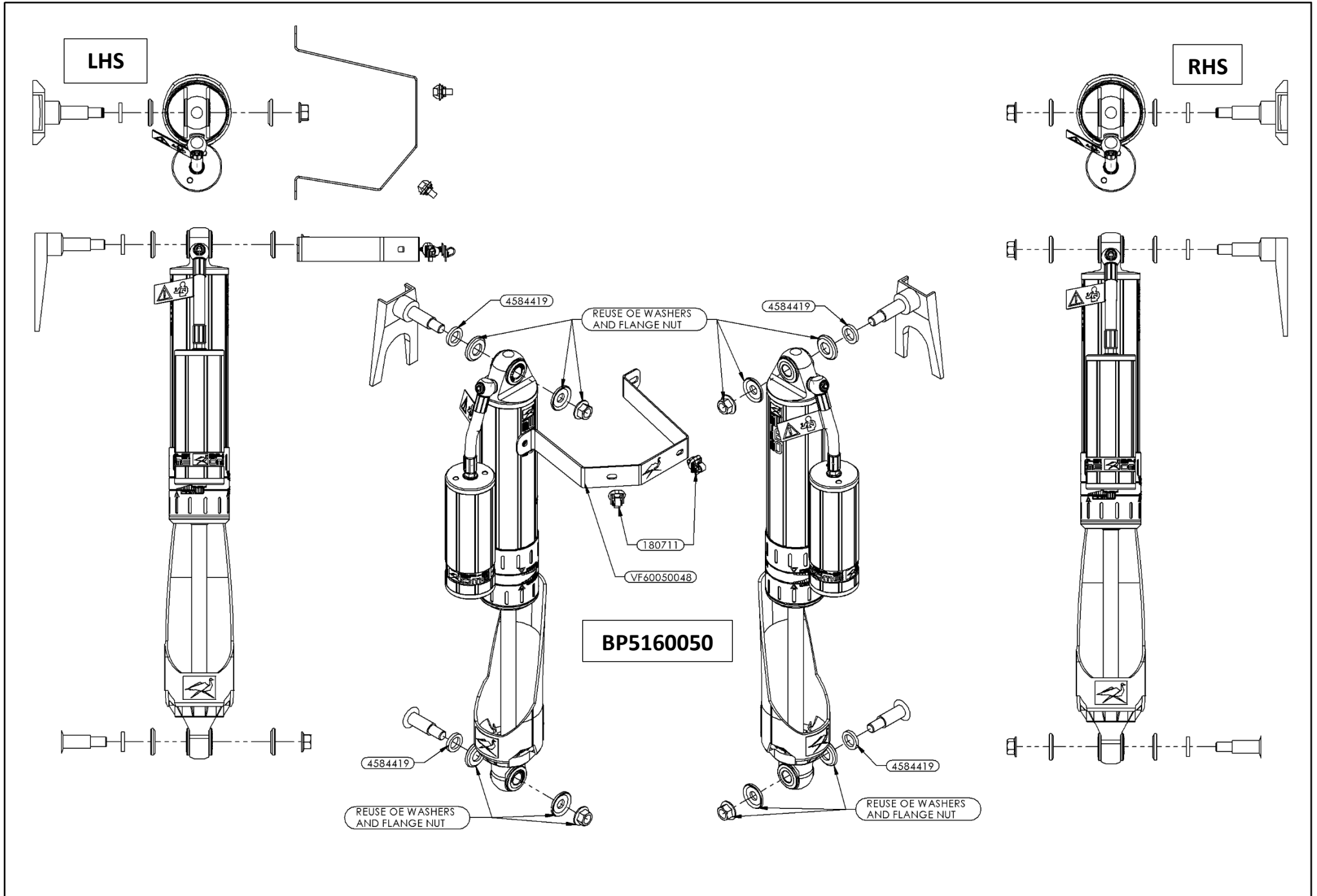

VEHICLE PREPARATION

BUMP STOP SPACERS

Using the table below, add bump stop packers (5848494) to achieve the minimum bump stop spacing of 70mm

Leaf Spring Part Number	Number of 5848494 packers required	Approx Total Stack Height (including spacers)
OE (STOCK)	3	71mm
EL123R	2	72mm
EL124R	1	73mm
EL125R	0	70mm

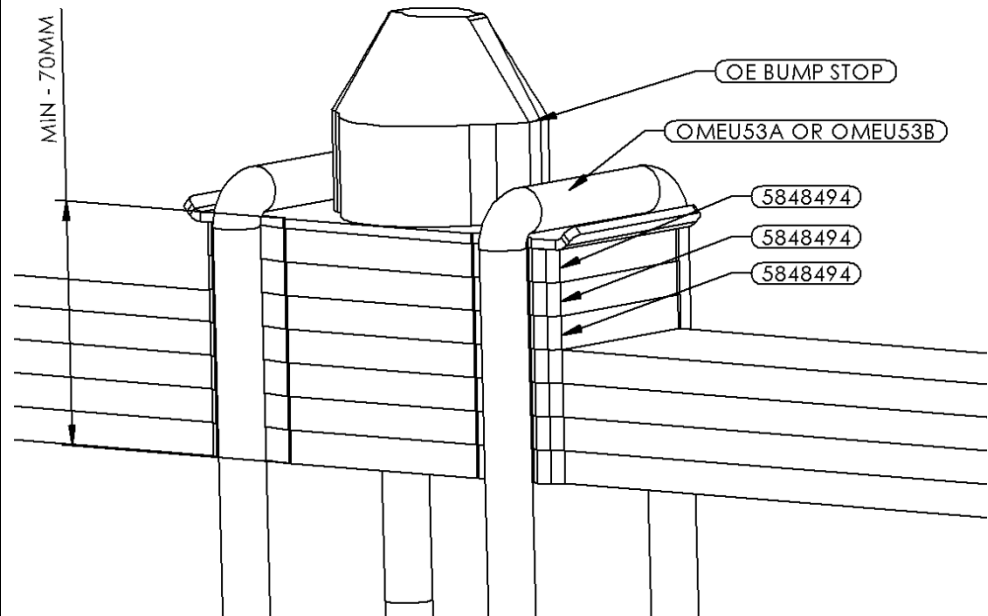

DAMPER PREPARATION

RESERVOIR MOUNTING

Fit the reservoir to the BP-51 using VM20010001.

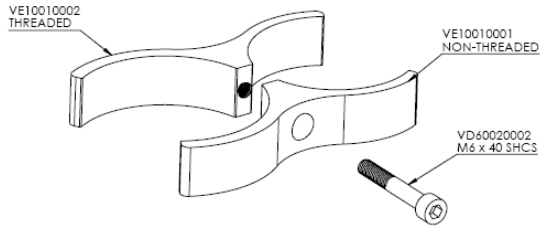

Fit the reservoir such that the hose assembly is rearward.

Set vertical position of the reservoir as shown to ensure stone guard does not impact reservoir bracket

BP5160050 LHS

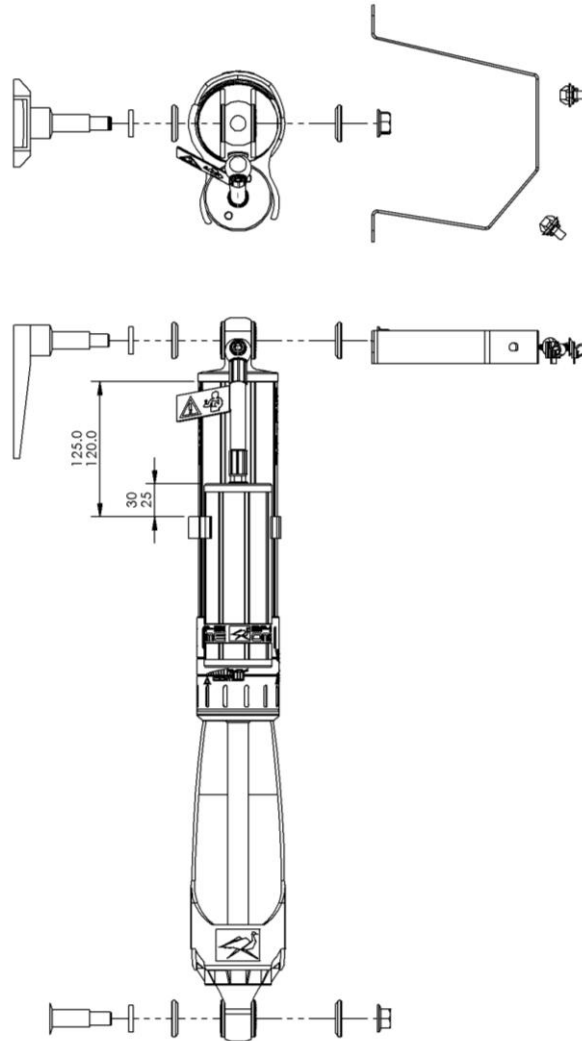

BP5160050 RHS

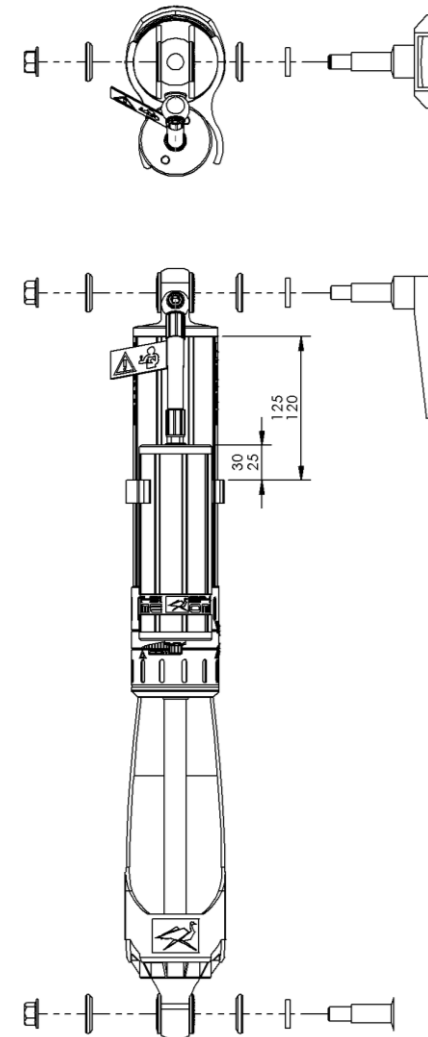

DAMPER PREPARATION

SECURING SHAFT GUARDS

The shaft guards are designed to protect the shaft from stones thrown from the front wheels and are mounted to the front side of the damper.

It is easiest to secure the shaft guards before the dampers are fitted to the vehicle.

Please follow steps 1-3.

1. Fit the two retainers to the eyelet as shown. Note the orientation.

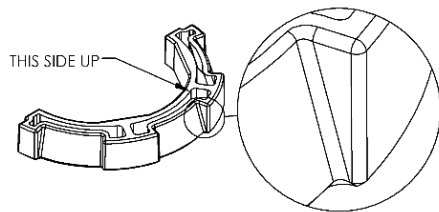

2. There are features on the shaft guard that locate in the gaps between the two retainers. Align the guard with these gaps and firmly pull the shaft guard down over the retainers to secure in place.

3. Check retainers are completely secured by guard. Use a flat blade screwdriver to poke retainers under tabs on guard if required. Refer to pictures (A) and (B) for correct fitment. **IMPORTANT: Ensure ALL tabs are fully retained.**

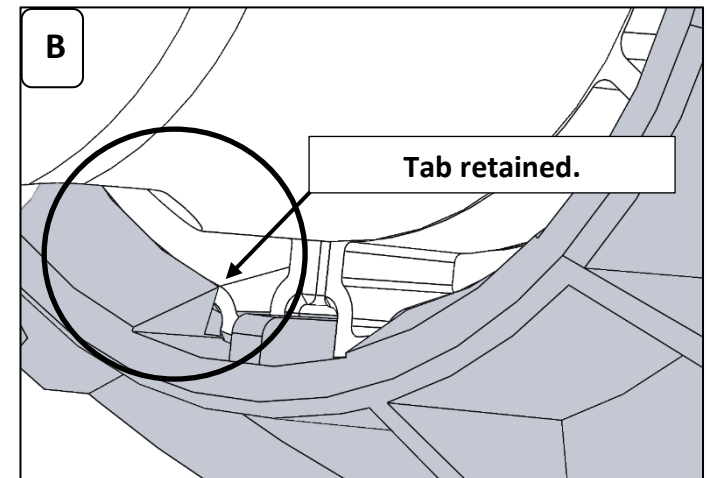
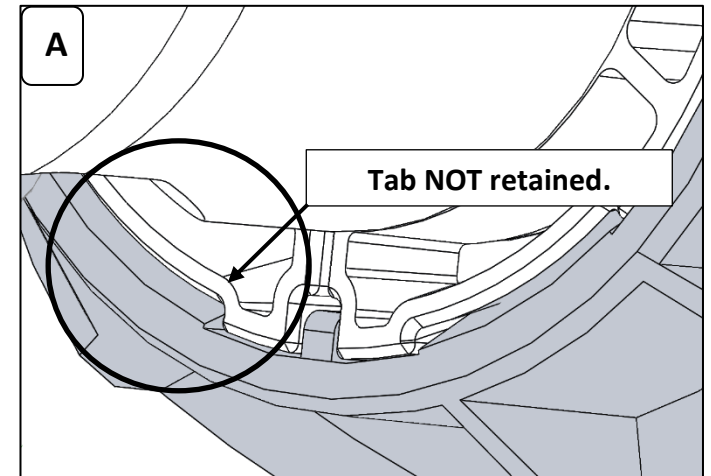
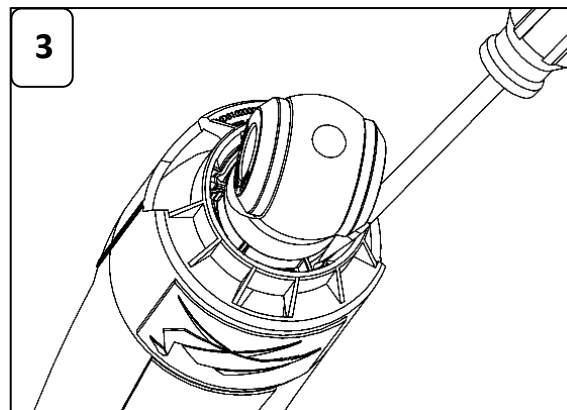
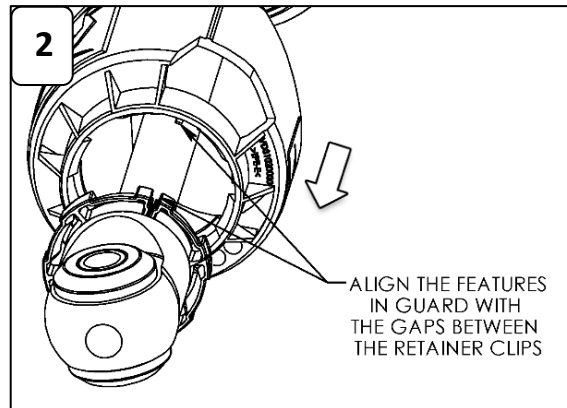
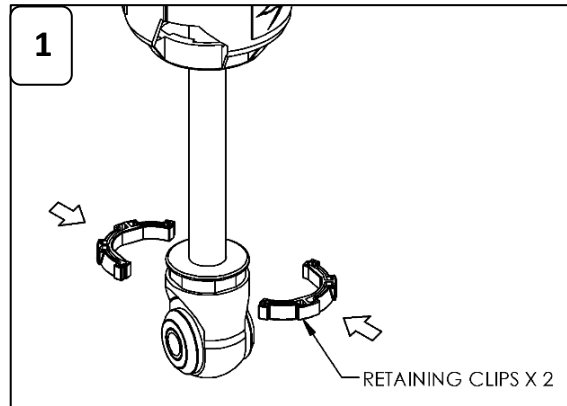

IMPORTANT: Ensure ALL tabs are fully retained

DAMPER MOUNTING SEQUENCE

LHS

Remove wiring loom bracket. Retain Christmas tree cable ties for re-use if possible.

Mount damper such that the reservoir is to the rear of the vehicle

Fit the damper top mount to the vehicle using OE and supplied parts in sequence as shown in the picture.

Ensure spacer 4584419 is installed behind OE washer as shown.

Once the BP-51 is mounted at the top, install VF60050048 loom bracket and mount the wiring loom with OE cable ties or 180711 supplied.

Install the lower mount to the vehicle using OE and supplied parts in sequence as shown in the picture.

Ensure spacer 4584419 is installed behind OE washer as shown.

Secure both top and bottom nuts and torque to

 **OE Mounting nuts: 39N.m (29 ft.lb)**

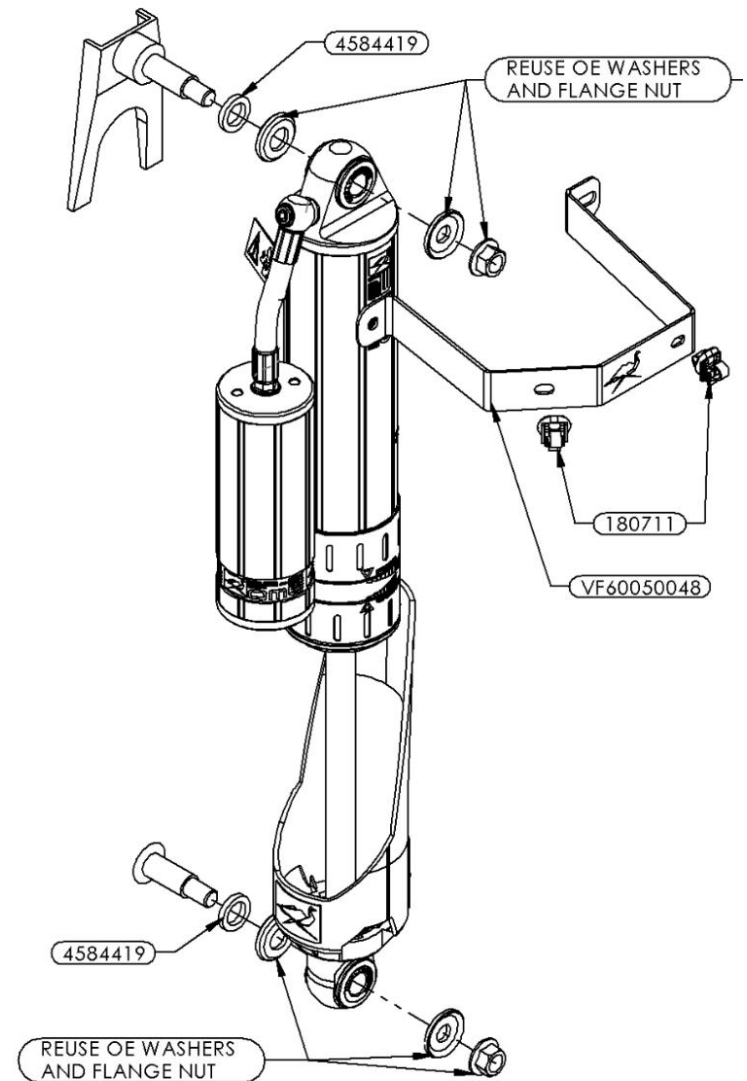
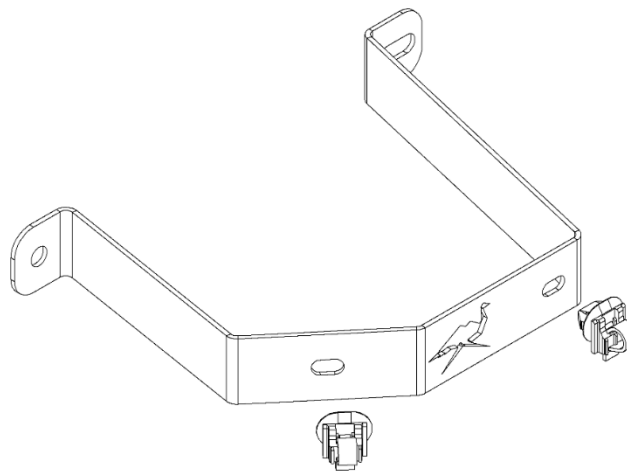

DAMPER MOUNTING SEQUENCE

RHS

Mount RHS as per LHS.

Mount damper such that the reservoir is to the rear of the vehicle

Ensure spacer 4584419 is installed to top and bottom mounts behind OE washer as shown.

Secure both top and bottom nuts and torque to

 **OE Mounting nuts: 39N.m (29 ft.lb)**

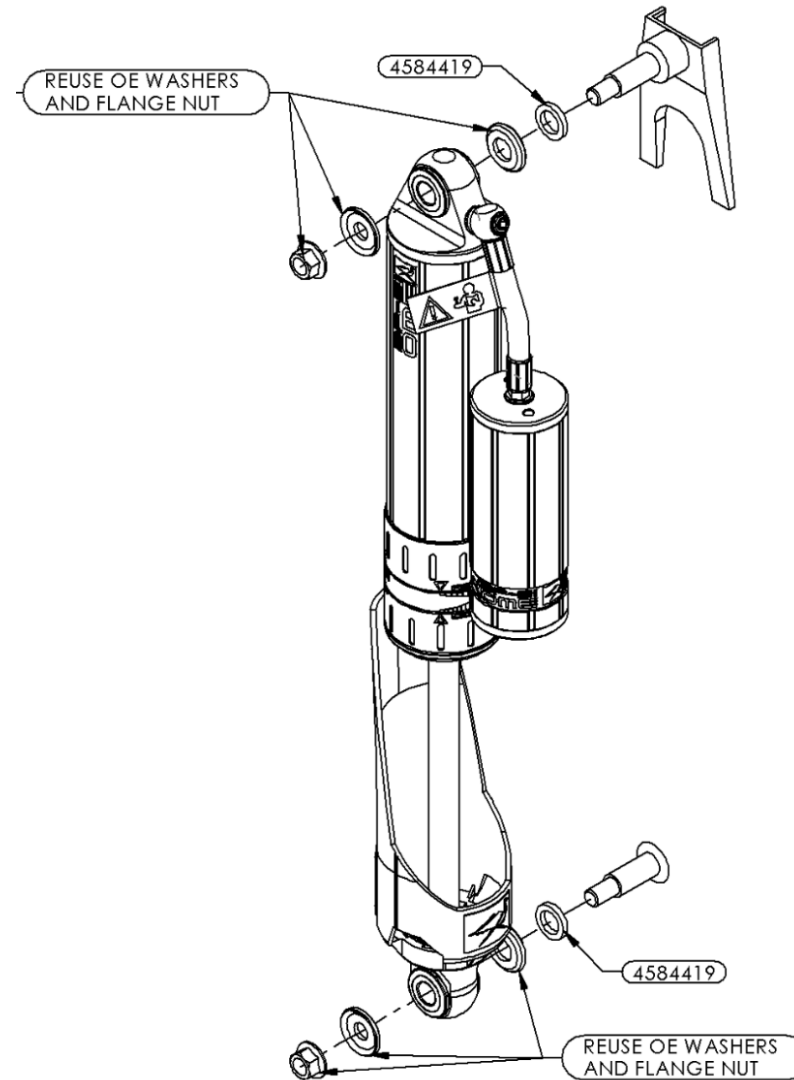

DAMPING ADJUSTMENT

These dampers have been set in the factory to be used for a vehicle with certain load.

If your load or accessory fitment differs, use the table below as a guide for recommended compression and rebound adjuster settings.

Part Number	Rear Pay Load (kg)	Compression	Rebound
BP5160050	0 - 200	0-3	0-3
	200 - 400	3-6	3-16
	400 +	6-10	6-10

SPECIFICATIONS

BP5160050	Extended Length	618 mm
	Compressed Length	393 mm

SPARE PARTS

Refer to Service And Parts Manual section:

- For BP5160016 see **BP-51 S&P 3.1-BP5160050**

BP5160050

