

FITTING INSTRUCTIONS

BP5160055L & BP5160055R FORD RANGER 22.75MY REAR

WARNING

- ◆ This product must be installed exactly as per these instructions using only the hardware supplied.
- ◆ In the event of damage to any suspension component, contact your nearest authorised ARB stockist. Repairs or modifications to the suspension system components must not be attempted.
- ◆ Do not use this product for any vehicle make or model, other than those specified by ARB.
- ◆ Do not remove labels from suspension components.
- ◆ This product or its fixing must not be modified in any way.
- ◆ The installation of this product may require the use of specialized tools and/or techniques
- ◆ It is recommended that this product is only installed by trained personnel
- ◆ These instructions are correct as at the publication date. ARB Corporation Ltd. cannot be held responsible for the impact of any changes subsequently made by the vehicle manufacturer
- ◆ During installation, it is the duty of the installer to check correct operation/clearances of all components
- ◆ Work safely at all times

Note: These fitting instructions should be read in conjunction with the vehicle workshop manual.

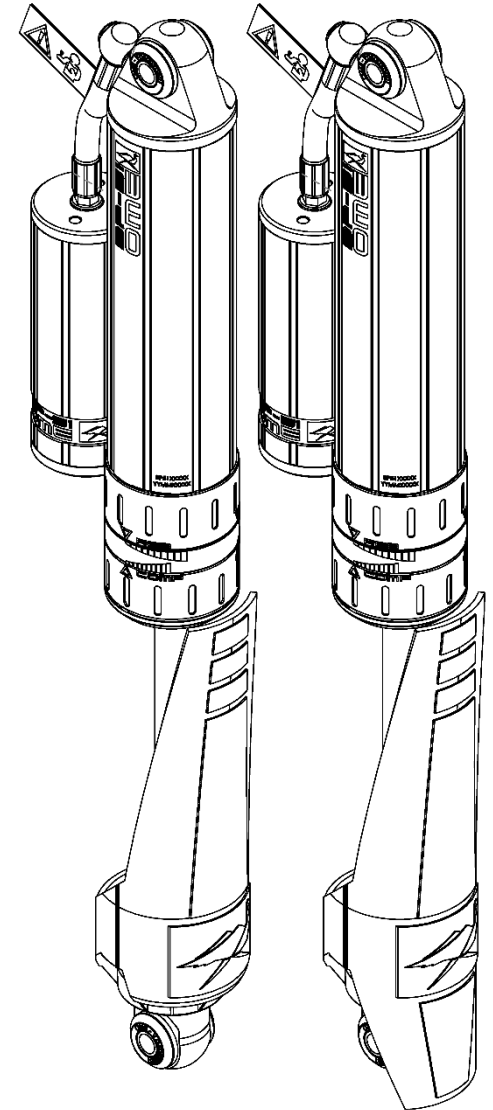

FITTING KIT CONTENTS – VM80010052

Item	Description	Qty	Part No.
1	RESI CLAMP ASSEMBLY	2	VM20010001SP
2	ADJUSTER TOOL	1	VC10010071SP

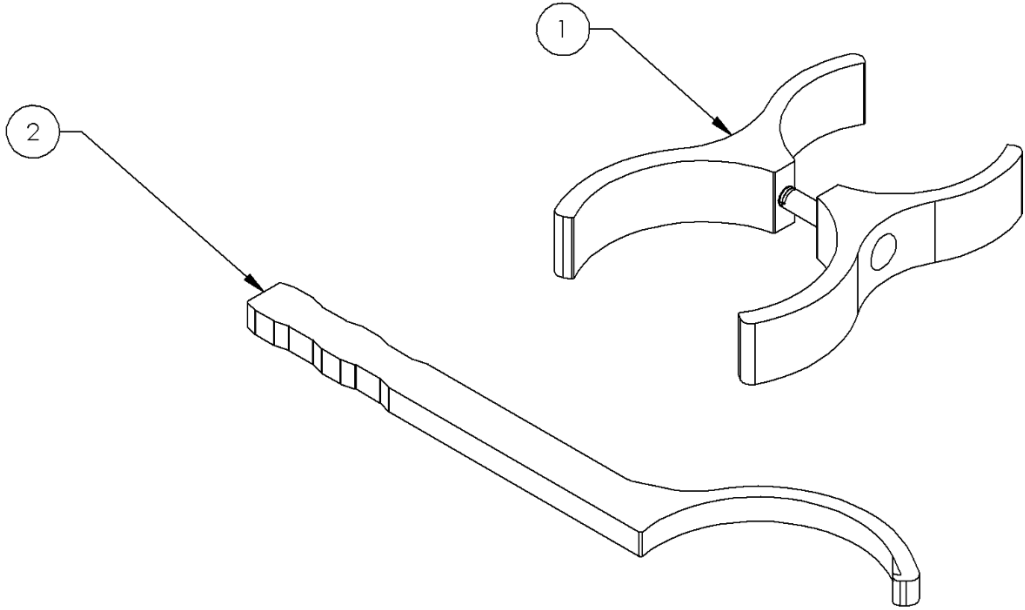

DAMPER PREPARATION

Left and right setups are different.

The left hand side has the shorter stone guard and is mounted behind the axle when installed on the vehicle.

The right hand side has the longer stone guard and is mounted in front of the axle.

Before fitment, the reservoir needs to be clamped to the damper body.

Refer to diagrams for orientation.

Shaft guards are secured before the dampers are fitted to the vehicle as illustrated in the next page.

Note the orientation of the eyelet and the hose before installation. The hose **MUST** be orientated towards the rear of the vehicle.

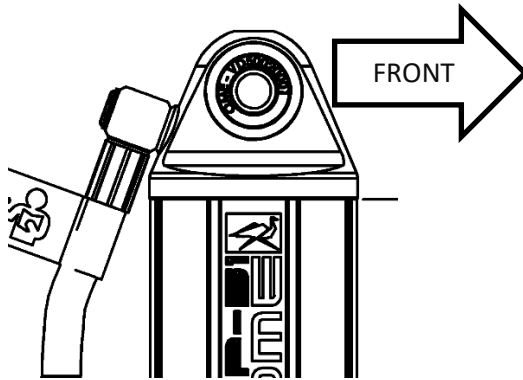

LEFT

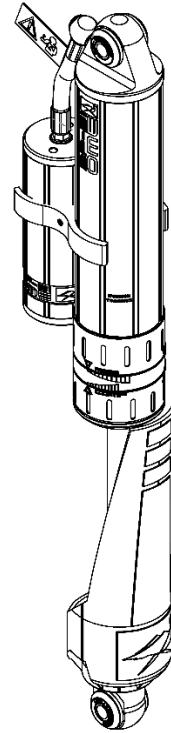
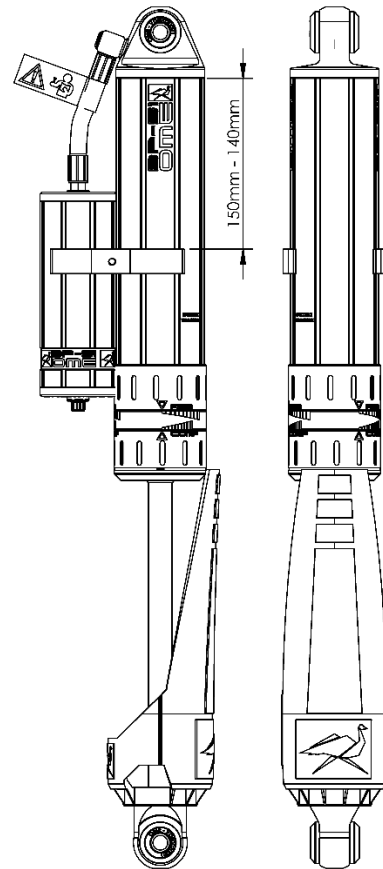
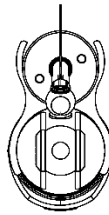

RIGHT

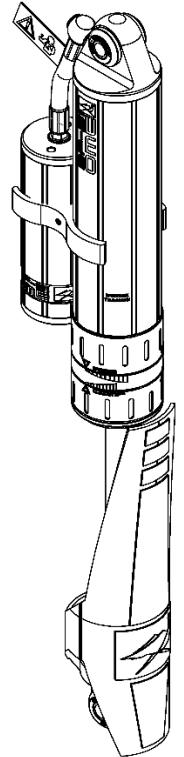
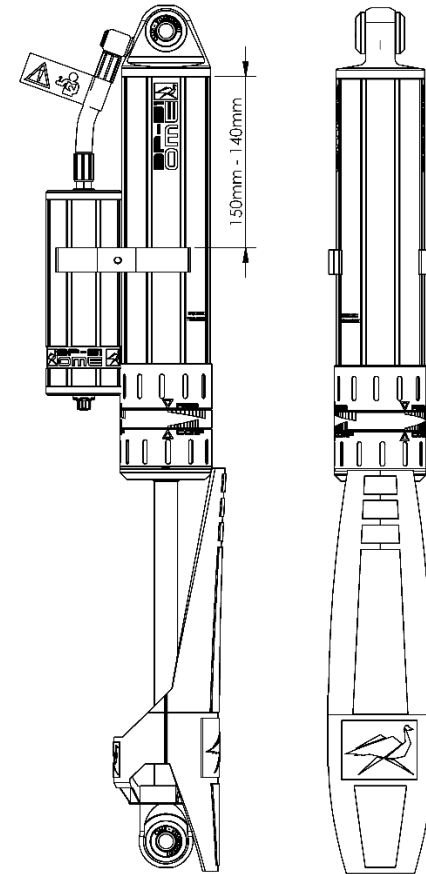
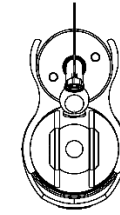

DAMPER PREPARATION SECURING SHAFT GUARDS

The shaft guards are designed to protect the shaft from stones thrown from the front wheels and are mounted to the front side of the damper. The longer shaft guard is fitted to the RH damper that is mounted on the front of the axle. The shorter shaft guard is fitted to the LH damper.

It is easiest to secure the shaft guards before the dampers are fitted to the vehicle.

Please follow steps 1-3.

1. Fit the two retainers to the eyelet as shown. Note the orientation.

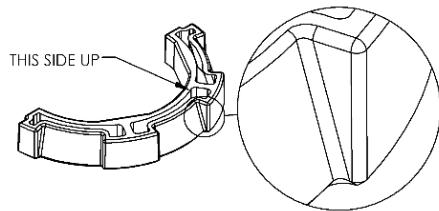

2. There are features on the shaft guard that locate in the gaps between the two retainers. Align the guard with these gaps and firmly pull the shaft guard down over the retainers to secure in place.

3. Check retainers are completely secured by guard. Use a flat blade screwdriver to poke retainers under tabs on guard if required. Refer to pictures (A) and (B) for correct fitment. **IMPORTANT: Ensure ALL tabs are fully retained.**

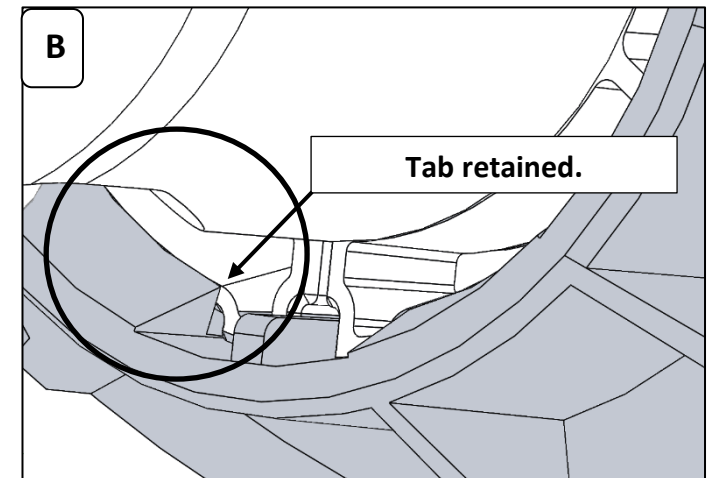
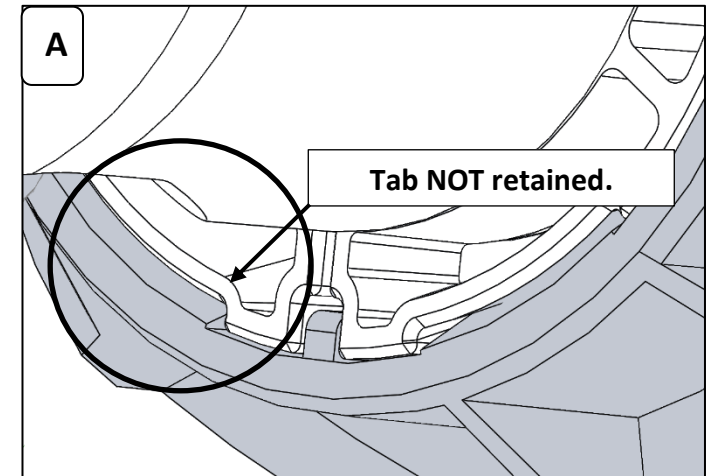
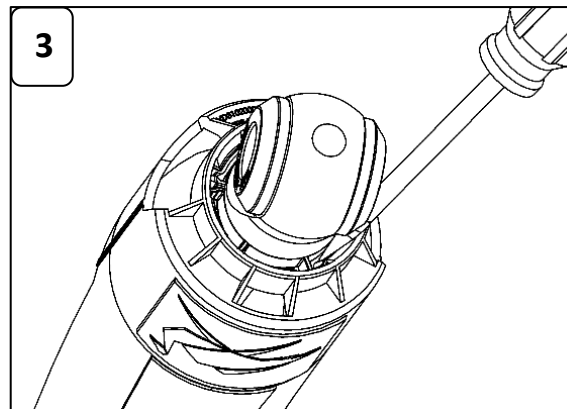
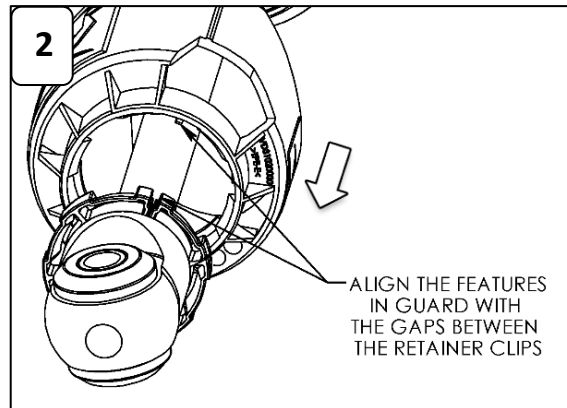
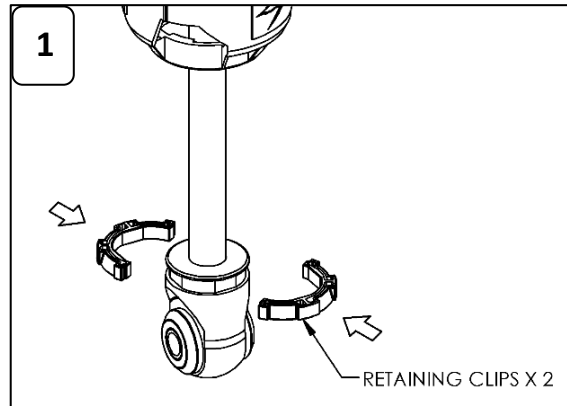

IMPORTANT: Ensure ALL tabs are fully retained

MOUNTING SEQUENCE

Remove old dampers from vehicle.

The BP-51 needs to be fitted with the suspension in droop.

Mount the dampers using the original hardware in the sequence as shown in the diagram.

Fit the top mount and droop the the wheel to secure the bottom mount.

Ensure the hoses are clear of any obstructions and have no kinks.

NOTE: The clamp should never be fitted lower on the damper body than specified as it may obstruct the path of the stone guard at full compression. (see p3.)

Securely tighten top and bottom fasteners. Refer to OE owner's manual for correct torque settings.

 **OE Strut Bolts, 80 N.m (59 ft.lbf)**

LEFT
REUSE ORIGINAL

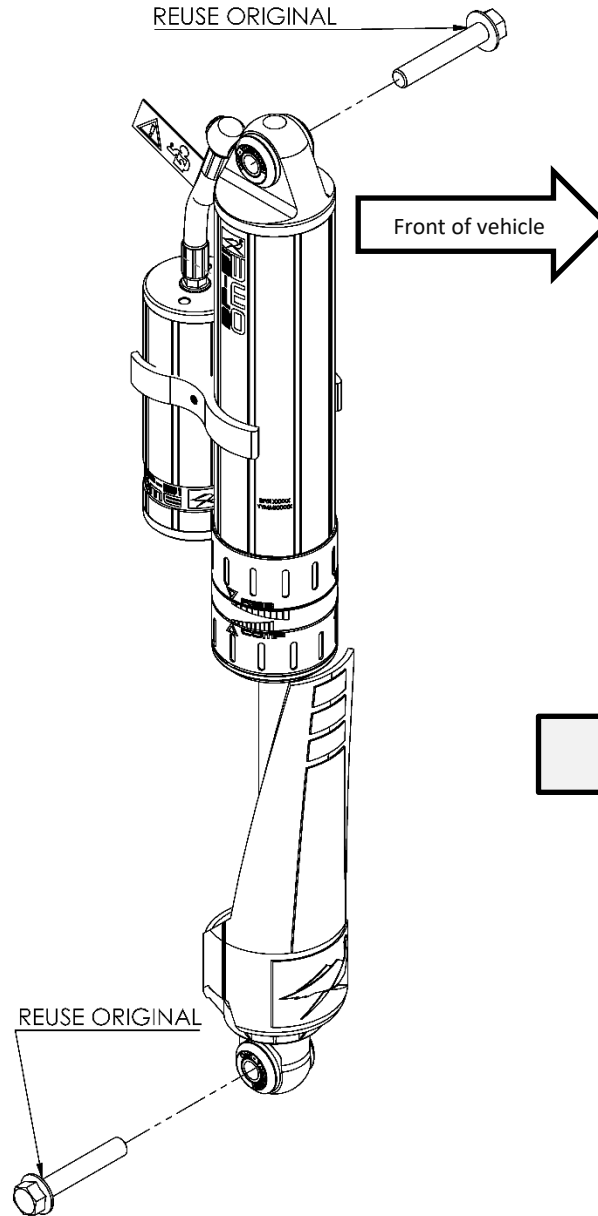

RIGHT

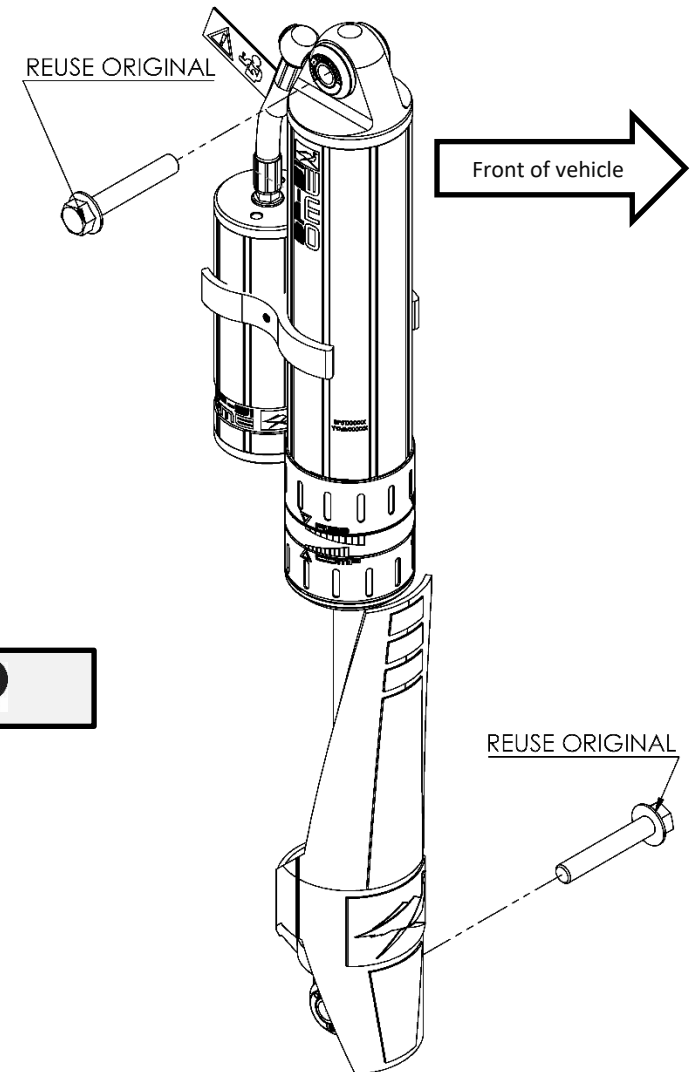

DAMPING ADJUSTMENT

These dampers have been set in the factory to be used for a vehicle with certain load.

If your load or accessory fitment differs, use the table below as a guide for recommended compression (Comp) and rebound (Reb) adjuster settings.

Part Number	Rear Pay Load kgs	Comp	Reb
BP5160055L&R	Factory settings	0	3
	300 – 600	0-3	0-3
	600 – 900	3-6	3-6
	900 – 1080	6-10	6-10

SPECIFICATIONS

Extended Length	663 mm
Compressed Length	413 mm

SPARE PARTS

Refer to Service And Parts Manual, section: **BP-51 S&P 3.1-BP5160055L&R**

